

Intelligent Swing Gate Turnstile

CPW-116Y

Product Manual V3.2



Shenzhen CMOLO Intelligent Technology Co., Ltd.



Contents

Product Description.....	1
Structure Chart.....	2
Dimension Figure (Unit: mm)	2
Product Parameters.....	3
Product Function.....	3
Product Customization.....	6
Contact Us.....	7

Product Description

Intelligent swing gate turnstile CPW-116Y with bridge type is transparent and bright, simple and elegant; the housing made of stainless steel is durable; the mechanism modules are imported from Europe brushless DC motors and precise positioning encoder, so as to make sure the swing gate can move quickly and accurately, stably and quietly, with low-power consumption, energy conservation and environment protection.

Feature

- ✧ Use DC brushless motor and encoder instead of servo motor to ensure that gate can move quickly & accurately and reduce mechanical fatigue of mechanism effectively.
- ✧ By using 10 pairs of military level high-performance infrared sensors and exact algorithms, it can accurately detect the pedestrian's passing position to achieve the purposes such as anti-tailgating, anti-reverse passing, anti-clamping and so on.
- ✧ Adopt CMOLO's original sunlight resistance design, reducing the interference on infrared sensors from sunlight.
- ✧ Adopt multiple anti-clamping designs, such as infrared anti-clamping, machinery anti-clamping and advanced electric current detection anti-collision in turnstile industry, to maximally protect the personal safety of pedestrians.
- ✧ The wider lane is optional for carrying luggage and wheelchair access.
- ✧ Equipped with the dry contact signal input interface, RS485/RS232 interface, TCP/IP interface (optional), compatible with all kinds of access controllers.

Occasion Applications

It is suitable for the mineral mining bases, factories, tourist attractions, residential community and other outdoor applications.

Structure Chart

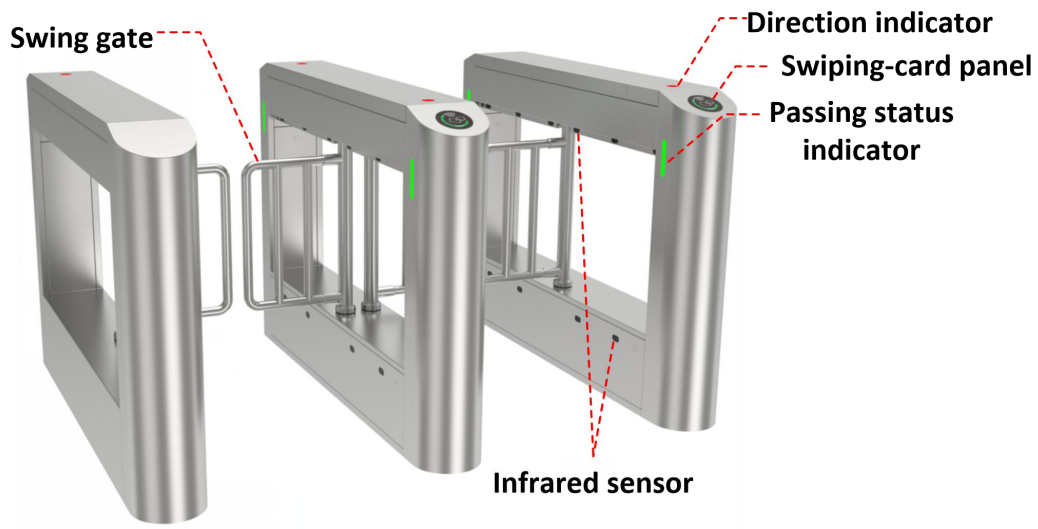

Dimension Figure (Unit: mm)

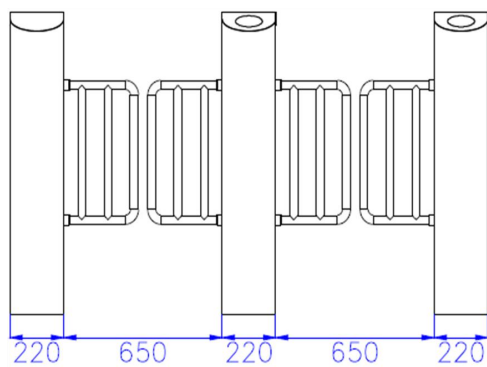

Front View

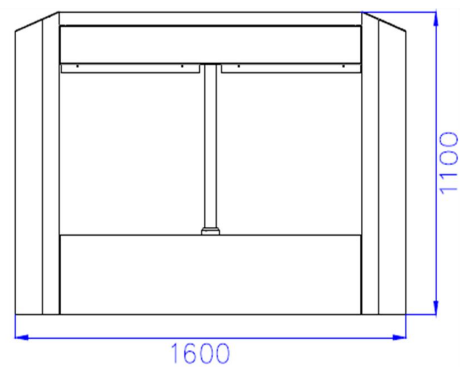

Side View

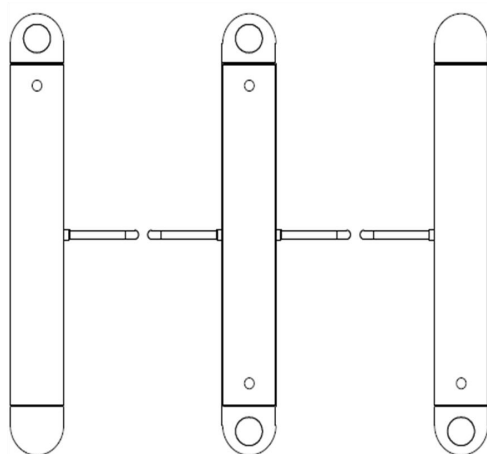

Top View

Product Parameters

Structure Parameters	
Housing material	304 grade stainless steel
Surface treatment	Brushed finish
Swing gate material	304 grade stainless steel elastic gate
Technical Parameters	
Normal throughput capacity	30 ~ 45 people / min (according to the condition of pedestrians)
Evacuation throughput capacity	60 people/min (according to the condition of pedestrians)
Opening speed	0.3-0.6s
The turning angle	±90°
Operation temperature	– 20℃~60℃
Anti-clamping technology	Triple anti-clamping designs (infrared anti-clamping + machinery anti-clamping + electric current detection anti-clamping)
Electric Parameters	
Power supply	100-240VAC, 50/60Hz
Rated power	100W
Control input/output	12 channels relay control output / 8 channels dry signal input
Communication interface	RS485 / RS232; TCP/IP interface (customizable)
Driving motor	DC brushless motor
Positioning method	Use the encoder to position the swing gate accurately
Method of motor control	Use high-performance DSP chip

Product Function

● Basic Function

- **Passing mode switching function:** The entry and exit can be set independently **【controlled mode】** / **【 free mode 】** / **【 forbidden mode】**
- **Automatic reset function:** The turnstile will open the gate after receiving the valid opening signal when standby. The swing gate will return to the hindered zero position automatically under the following situation:
 - (1) Within the allowed time, pedestrians have been detected to pass through the passage in specified direction;

(2) Over the allowed time, there is no people has been detected to pass through the passage.

- **Self-recovery function:** The swing gates do not return to the hindered zero position because of human intervention. After revoking human intervention, the gate automatically returns to the hindered zero position.
- **Automatic adjustment function:** When the turnstiles need to readjust because of mechanical wear, the main control board can adjust automatically, accurately and conveniently.
- **Memory function of passing requests:** When more than 2 passing signals are given at the same time (including the same direction and opposite direction), the system will remember all the passing requests and finish them one by one. The number can be up to 255.
- **Passing direction indicator:**

(1) Direction indicator: The direction indicator is installed on the top of the housing to indicate the legal passing direction.

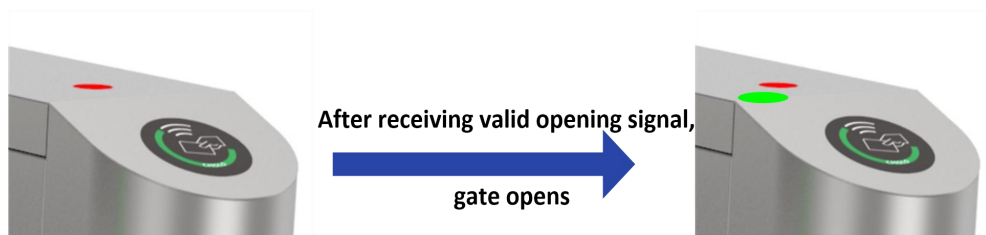

(2) Passing status indicator: It is installed inside the housing, indicating whether the swing gates can open after receiving the valid signal.



Turnstile standby
This direction is in the passing state



No passing in this direction
The opposite direction passing is not over yet

- **Compatibility:** Equipped with the dry contact signal input interface, RS485/RS232 interface, TCP/IP interface (optional), compatible with all kinds of access controllers.
- **Security Design**
- **Self-check function when power on:** The system will self-check routinely and alarm when the power is on, and intelligently detect the key hardware and function. Find the hidden danger within the shortest time!

- **Open gate when power off:** Adopt the leading mechanical structure by original creation; the system will open the gate automatically when power off or manually push the gate to be open so as to evacuate people conveniently, which meets the firefighting requirement.

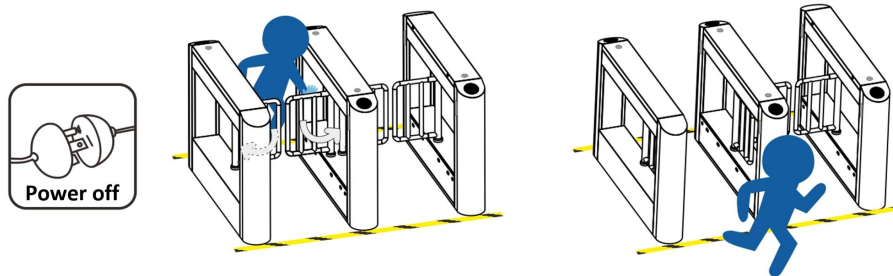

- **Anti-clamping function:**

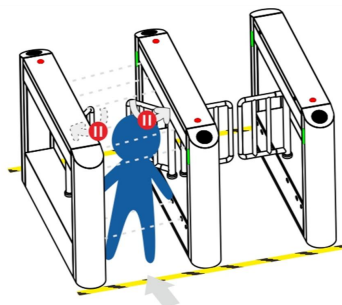

Infrared anti-clamping



Machinery anti-clamping

(1) Infrared anti-clamping: Install multiple pairs of infrared detectors near the swing gates' moving area(anti-clamping area).Once people or thing is detected within the anti-clamping area, the gate will automatically stop moving; until people or thing leaves the anti-clamping area, the gate will continue to move.

(2) Machinery anti-clamping: The swing gate will automatically stop moving when it encounters obstacles; the impulse force is within the safety range when the swing gate is moving.

(3) Electric current detection anti-clamping: if the gate encounters obstacles during its moving, and the system detects the abnormal current, the motor will stop or reversely move to prevent clamping pedestrian.

- **Anti-collision function :** When the gate is locked, it can support the impulse force within the safety range. The gate can be manually pushed slowly when the impulse force is over the safety range, to protect the mechanism and pedestrian, and then recovers automatically.
- **Emergency escape function :** Equipped with emergency escape control device, the system can automatically open the gate to evacuate pedestrians conveniently.

- **Intelligent linkage alarm:** Illegal traffic events can be linked with other alarm monitoring equipment: such as access control systems, video management systems.

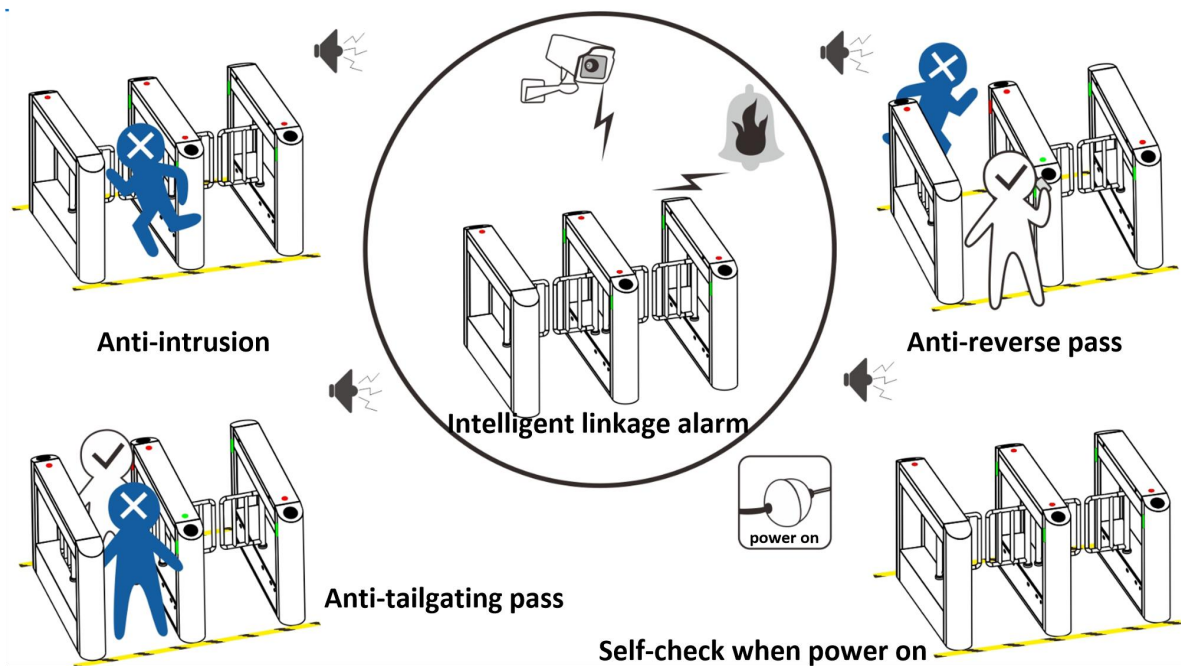

Product Customization

● Customized Functions

- Built-in or external counter
- TCP / IP communication

● Gate open button

- External door open button.
- Install the gate open button with wireless remote control.

● Thermostat system

Under a low temperature environment, the thermostat system can be installed inside the device.

● Materials

- The material of housing can be 316 grade stainless steel, and the thickness of stainless steel can be customized.
- The material of swing gate can be tempered glass, Acrylic and polycarbonate etc. and the color can be customized.

● System Integration

- Integrate with access control system and built-in reader provided by customers.
- Integrate with visitor access control system.
- Integrate with ticketing system.

★ Notes:

- (1) The product design and specifications are subject to change without prior notice.
- (2) Please contact us directly for special features customization.

Contact Us

Shenzhen CMOLO Intelligent Technology Co., Ltd.

ADD: CMOLO Industrial Park, 144-1 Hengping Rd., Henggang Street, Longgang District, Shenzhen

P.C.: 518115

TEL: 0755-83065161

FAX: 0755-83134161

E-mail: sales@cmolo.com

For more products' information, please visit our website: www.cmolo.com.

Or follow us:



Facebook



Twitter



Linkedin



Youtube