



深圳市赛尔瑞科技有限公司
SHENZHEN SEAORY TECHNOLOGY CO.,LTD.

Seaory S22 Card Printer Manual



June 2019

Statement

Copyright

Copyright© Shenzhen Seaory Technology CO.,LTD. All rights reserved.

Users shall respect the latest regulations on copyright of their own countries. This manual, no matter in E-file, text version, or other formats, can never be partially or totally copied, translated or spread in any way for any reason, without the writing authorization from Shenzhen Seaory Technology Co., Ltd. Please forgive that any change of this manual will not be further noticed. Shenzhen Seaory Technology Co., Ltd shall take no responsibility for any errors (if any) in this manual, accidental damage of printer, or losses caused by this manual contents.

All the pictures and specifications in this manual are made to help description, while the actual specifications shall be subject to order. If any query, please refer to the products specifications on the website of Shenzhen Seaory Technology Co., Ltd.

Warranty

With respect to warranty conditions and restrictive clauses, please refer to the Warranty Card enclosed in the printer package.

Knowing your new printer

Thanks for choosing Seaory S Series card printer, to start a successful cooperation between us. A variety of high quality personalization of identification cards, visa cards, and membership cards etc. can be realized through simply operation of these card printers. You shall make sure that printer consumables you bought are from original manufacturer. To know more information, please visit our website: www.seaory.com.

Preparation

The purpose of this manual is to help you setting the card printer. Before using, please read this manual carefully, and learn about the printer and its functions, which will save you time on installation and using. If any errors found, please let us know by mailing to: info@seaory.com.

Sign Helper

Below signs indicates key information of this manual.



Special Warning Message



More In-depth Information Notice

Catalogue

Chapter I Preparation.....	2
1.1 Inspection	2
1.2 Appearance Introduction	3
1.3 Installation	5
Chapter II Maintenance of Printer	26
2.1 Cleaning the card passage by cleaning card	26
2.2 Cleaning printer head	28
Chapter III Tips for Solving Problems	29
3.1 Warning and Tips for Errors.....	29

Chapter I Preparation









1.1 Inspection

The card printer is supplied with several accessories and please take time to check it closely. Kindly note that accessories may differ depending on which country you are.

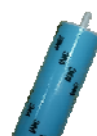
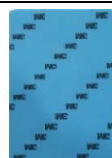

In case of missing of any below articles, please contact your local distributor immediately.

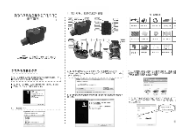
Table list of accessories come with S22 card printer:

S22 Accessories (Standard)	Power cable*1	Adaptor*1	USB cable*1	Cleaning rod*1	Cleaning roller*1	Cleaning cards*5
						
	Output hopper*1	CD*1	Manual*1	Warranty card*1	Counterweight card*1	
						

1.2 Appearance Introduction

1.2.1 S22/Desktop Dual Sided Card Printer

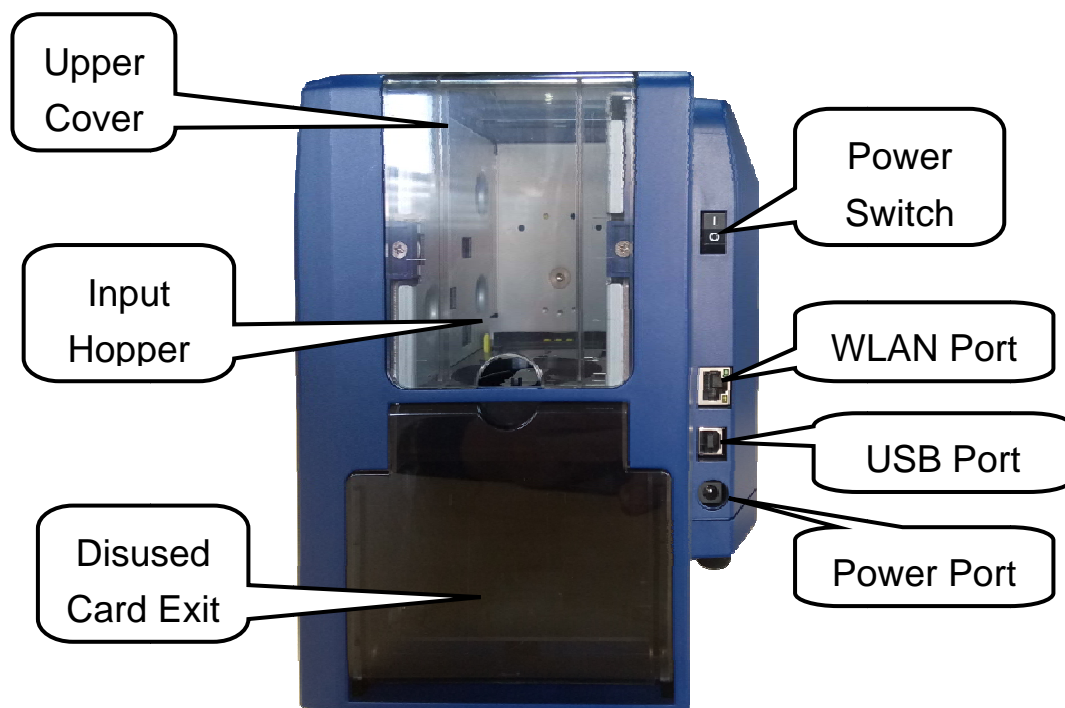
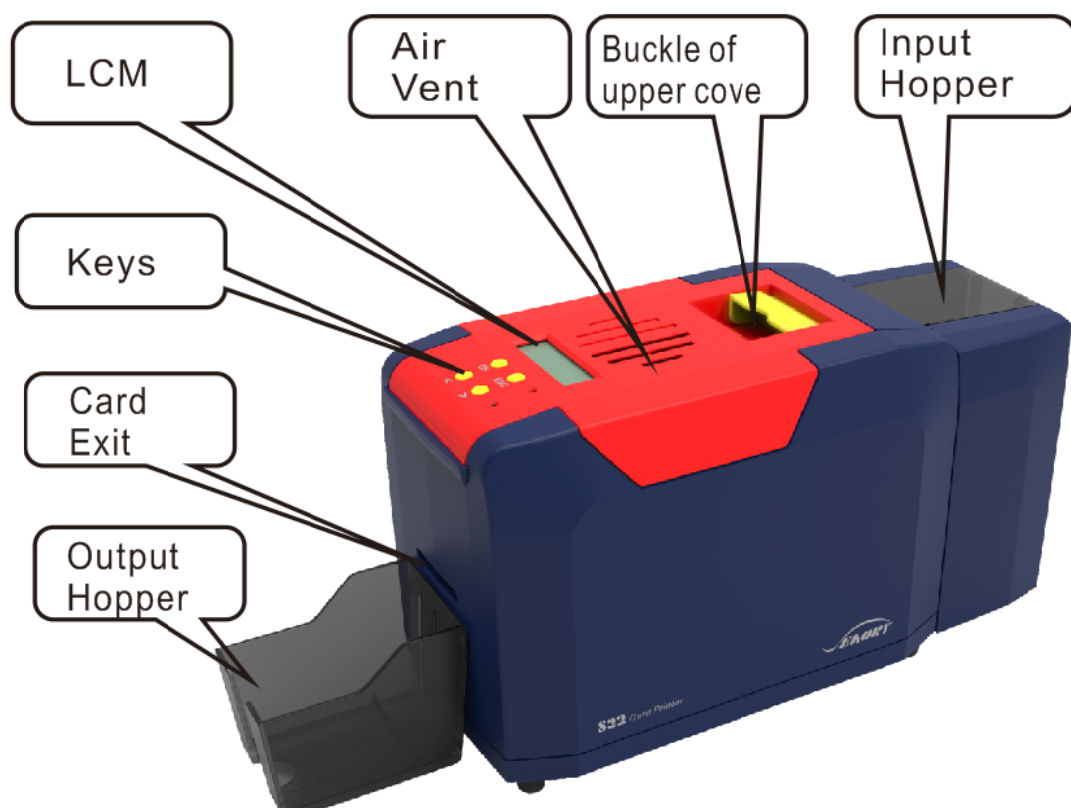

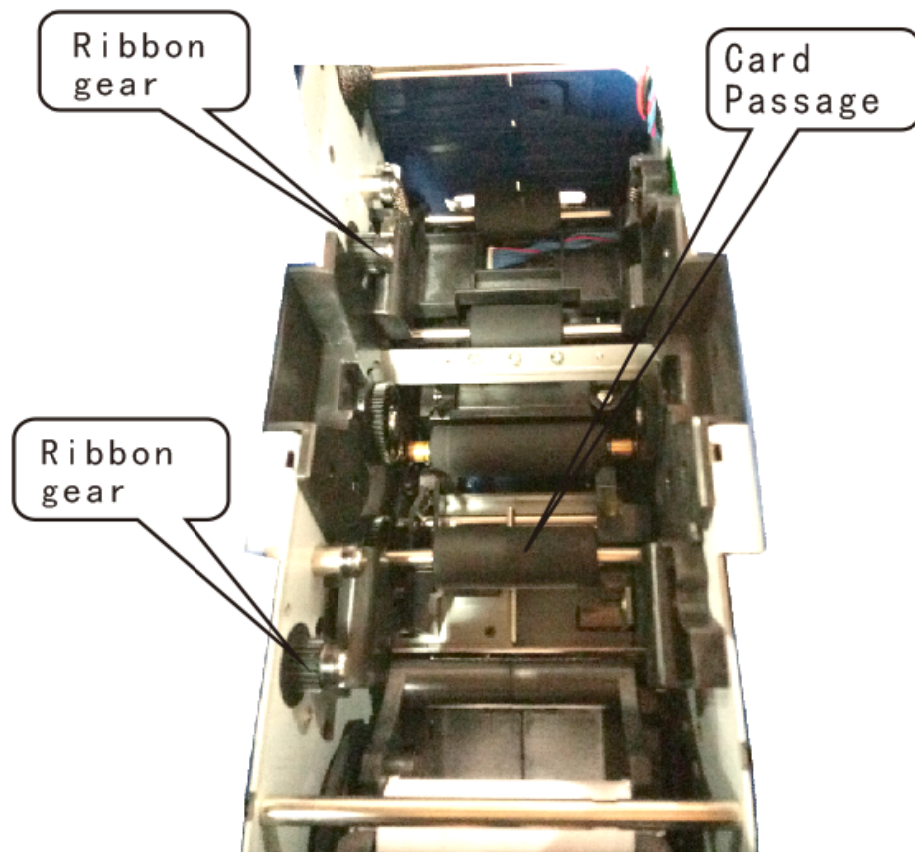
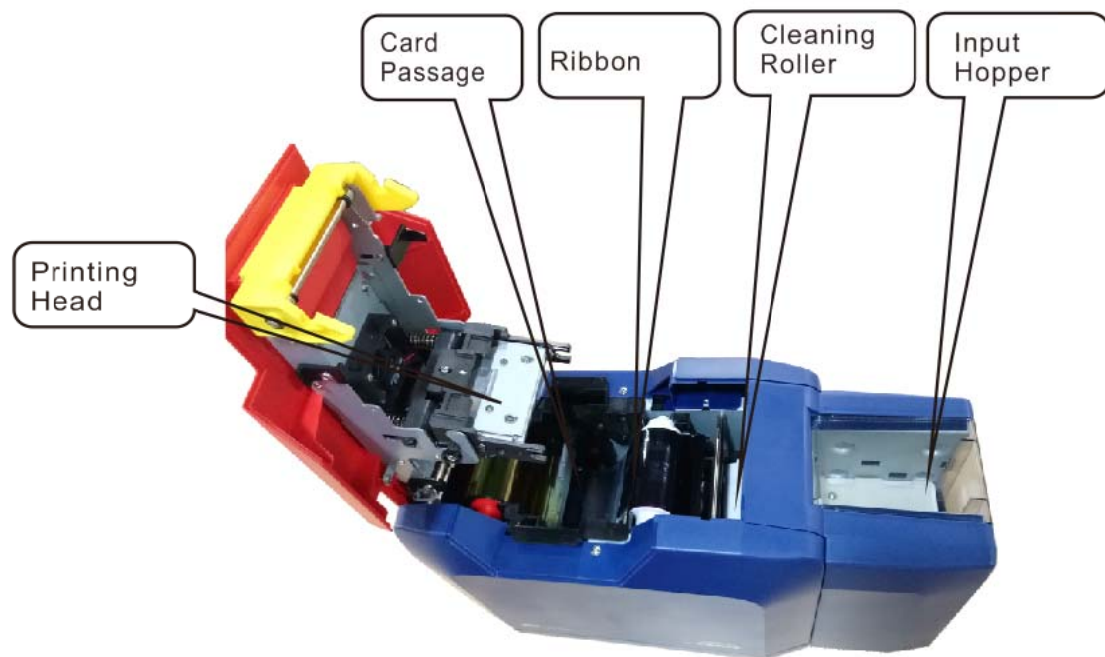



1.3 Installation

1.3.1 Placing of ribbon

Make sure to use original ribbons of Seaory S Series card printers, to protect your printer against from damages. Please pay attention that compatible ribbons may cause printers damaged or not work.

 To optimize printing quality, please engage in printer cleaning every time when the ribbon is changed.

- Open the cover;
- Unpack ribbon box and get out the ribbon carriage;
- Place ribbon on the carriage by color marks, and put the carriage into the printer.

 Please remember to place ribbon according to the color marks on the carriage, glossy side upward, ribbon dye side adown, and make sure the cover can be covered well after the carriage put in.

- Cover it slowly until a sound listened

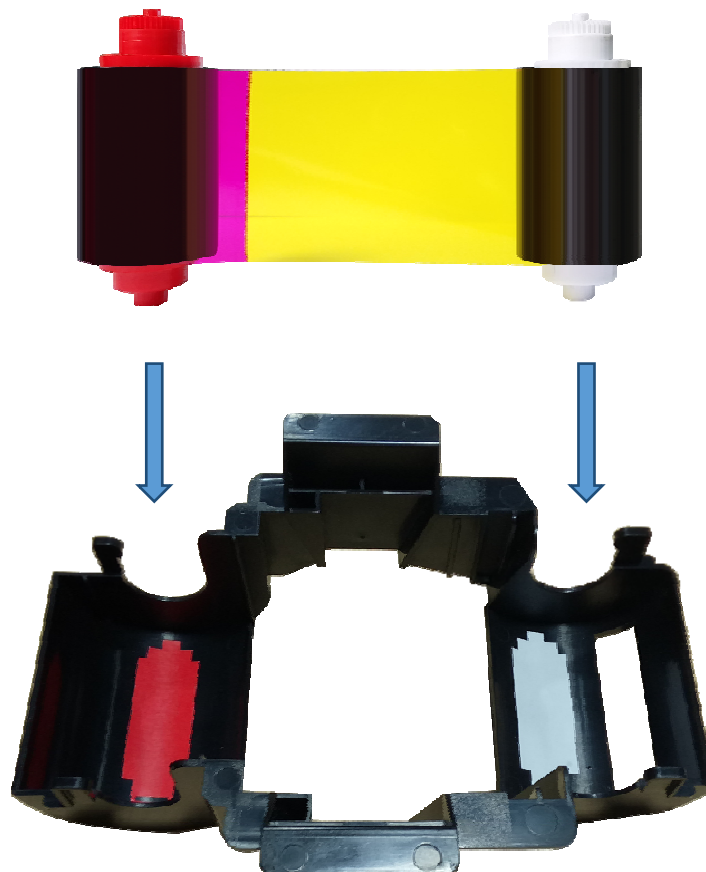

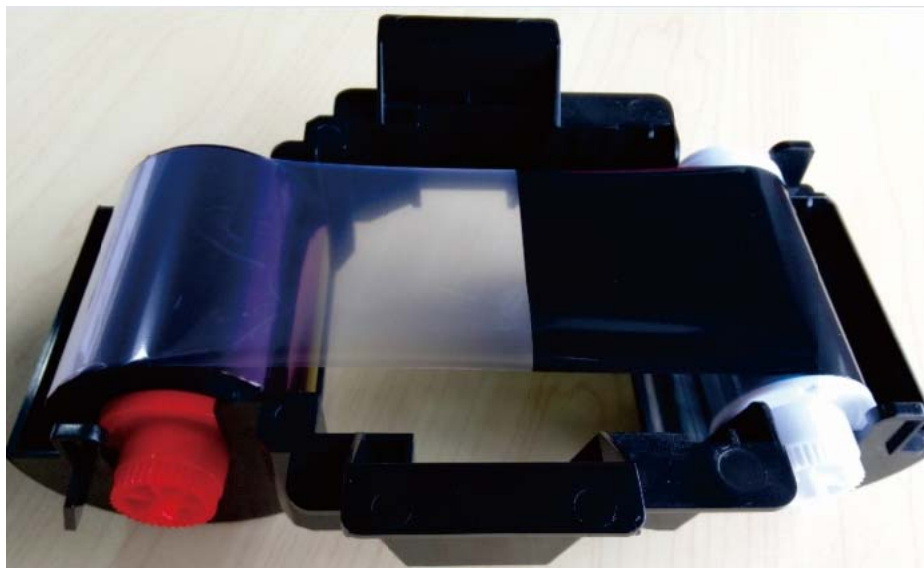

1.3.2 Connect card printer

Power Supply:

- a. Connect power cable with adaptor
- b. Connect the adaptor with the round supply hub of printer



Please make sure the power cable has been connected to a protective and grounding power supply.

- c. Please make sure the power cable has been connected to a protective and grounding power supply.



To keep your safety, please make sure the power is off and power supply has been pulled out, before you cleaning or maintaining card printer.

- d. When you need to set up network printing, insert the specified network interface into the network port of the device.





When connecting to the network interface, make sure that the network port is connected by the designated router, and set the router's DHCP to be automatically obtained. In addition, the network interface can only be used when printing on the network.

e. Open the power switch of printer, and make sure that it reads "Printer is ready" on the LCD, and that green light is on.



USB cable

- Connect the square mouth of USB with USB interface on printer
- Connect the flat mouth of USB with USB interface on computer



Please make sure driver has been installed in the computer correctly, before connecting USB cable with your printer and computer.

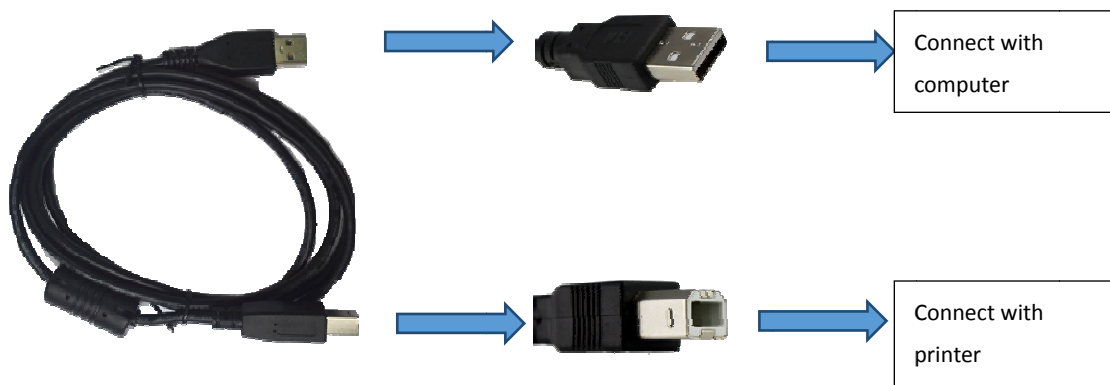

1.3.3 Placing cards

Automatic card-feeding



Please use CR80 or ISO 7810 cards to print, and do not touch the printing side of the card, avoiding any dirty, damaged or folded card, or card with embossing letters, to guarantee a best printing effect. The card thickness shall fit to the adjusting level. Otherwise, it will cause failure of card feeding or multiple-cards feeding at one time.



Cards can be put in the input hopper and they will automatically feed for the model of S22.

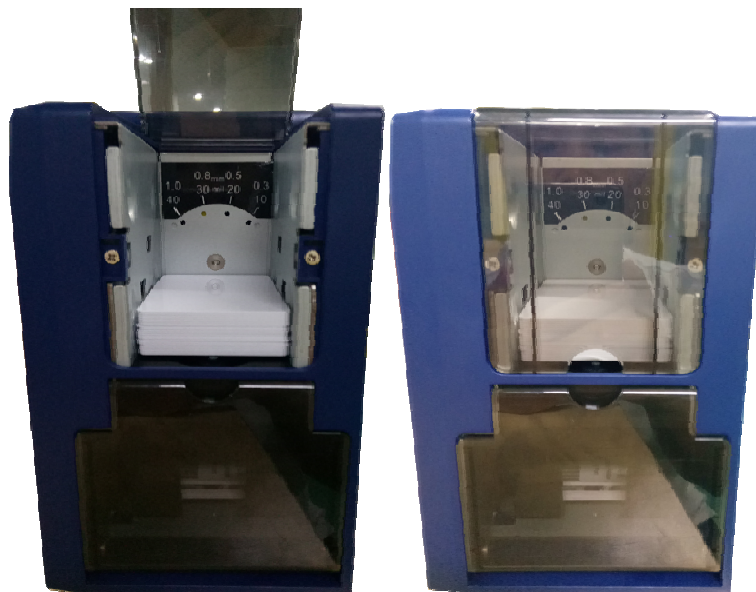

Hand-feeding single card



S22 support hand-feeding single card printing.

- To set up the card input pattern as Back end manual feed slot in printing preferences.
- Insert card manually to feed slot of printer
- Start Printing or designing the card through the software on your computer.

Feed card: —

Card feeder	▼
Card feeder	
Back end manual feed slot	
<input type="checkbox"/> Retry by hook mode	

Card Collection

When the printing/encoding is completed, the printed/encoded card will be returned into the output hopper which is designed with a capacity of 50x0.8mm cards. For eject card way, could be set to Output hopper, Reject tray or Do not eject card.

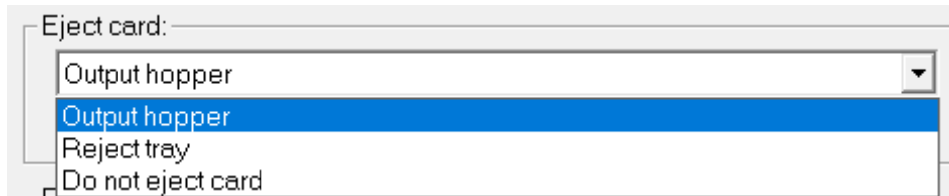

Card thickness adjustment

Seary S22 is equipped with a card thickness adjusting device, which is seated behind the input hopper inside the printer. Card thickness at factory initial value is 0.8mm (30mil), which can be adjusted from 0.3mm to 1.0mm (10 to 40mil). The card thickness shall fit to the adjusting level, otherwise, it will cause multiple-cards feeding at one time or failure of card feeding.



Card Thickness Adjustor

- Open the top cover of printer
- Adjust the thickness level by moving the lever to preferred thickness setting (The thickness is 0.8mm in shown in diagram).
- Close the top cover of printer.



S22 Input Card location

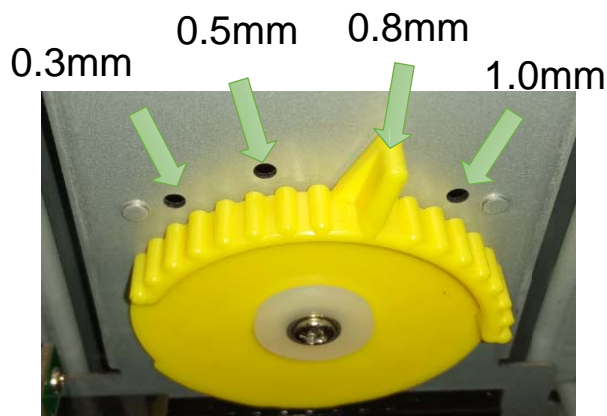

S22 Inside

1.3.4 Installation of driver



To keep your safety, please make sure the power is off and power supply has been pulled out, before you cleaning or maintaining card printer.

Before using this printer, it is very important to correctly install the driver and software as well as do settings, which shall attract special attentions from users, because improper using and operation will affect printing quality. Therefore, users shall install and operate, and do settings totally based on this manual. In case that it does not meet expected results after adjustment, ways to reset the printer have also been provided to you.

A CD is bundled with the printer which contains the printer driver for Microsoft platform.



In case of no CD included, please contact your local distributor immediately.

To begin installing a print driver, please put the CD into the CD-ROM of your computer, open the CD-ROM and select the printer driver menu, making sure all installation steps are correct.



Some users may need to own administrator right of computer at the installing of printer driver in some Windows computers.

- a. Please cancel all antivirus applications, and disconnect the printer with computer, before installing printer driver.
- b. Double-click the icon "Seatory S series driver 0.9.13.2.exe", the below window will come out, then click "Install" button. (Note: Please download the latest driver program on Seatory official website occasionally.)

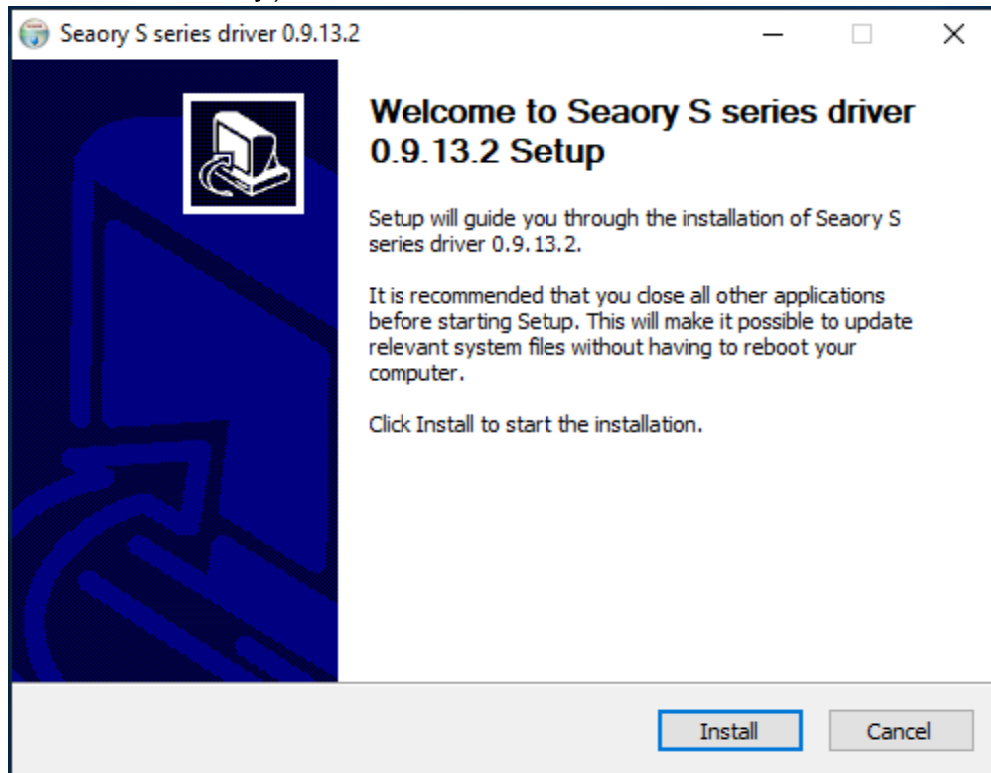

- c. Installing, please wait patiently.

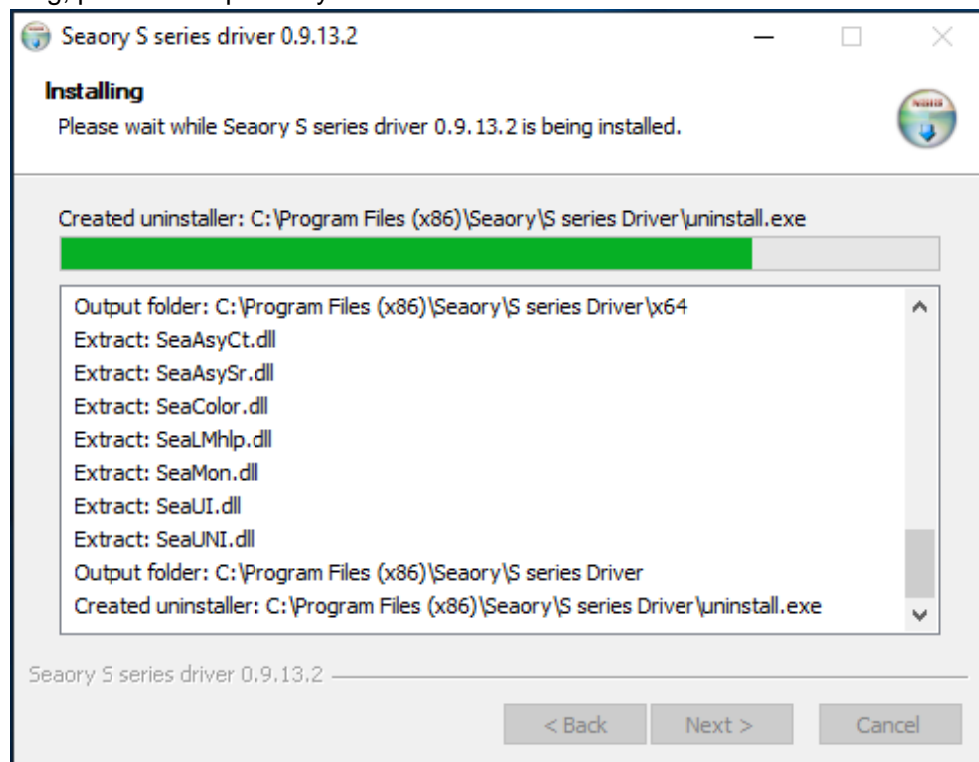

d. In the pop-up dialog box, click the "Finish" button, the driver has been installed, and if you want to achieve network printing, you need to check "Set Network Printer", do not check if you do not use network printing.

Check "Set Network Printer" to set up the network printer and click Finish.

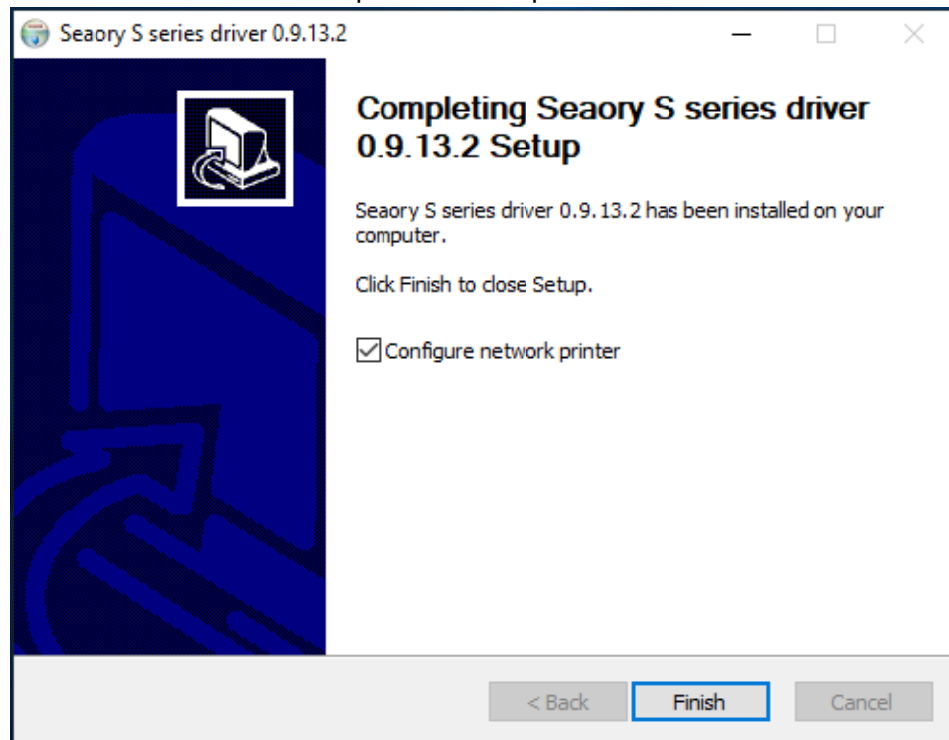

e. In the pop-up "Serre Network Printer Setting Tool" dialog box, select "Auto Search" and click "Start Search". At this time, the S22 model card printer will be automatically searched, and the IP address is automatically obtained. For this model, click on "Add Printer".

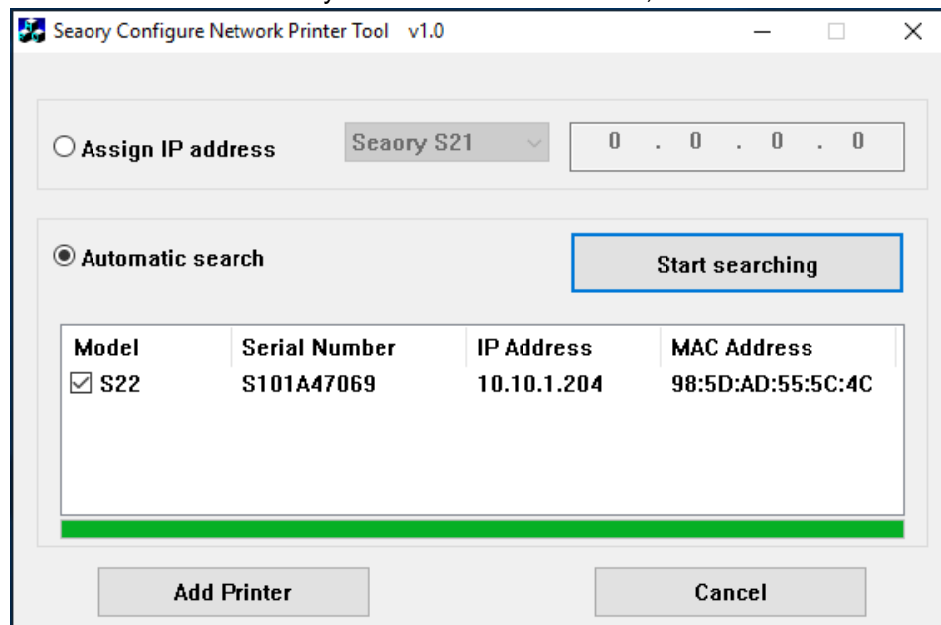

f. After clicking the button of “Add Printer”, connect the printer with computer by USB cable, open the power switch of printer, when it reads “Printer is Ready” on the LCM and green light is on in the same time. Click “Start”/“Devices and Printers” then you can find Seaory S22 was installed completely.

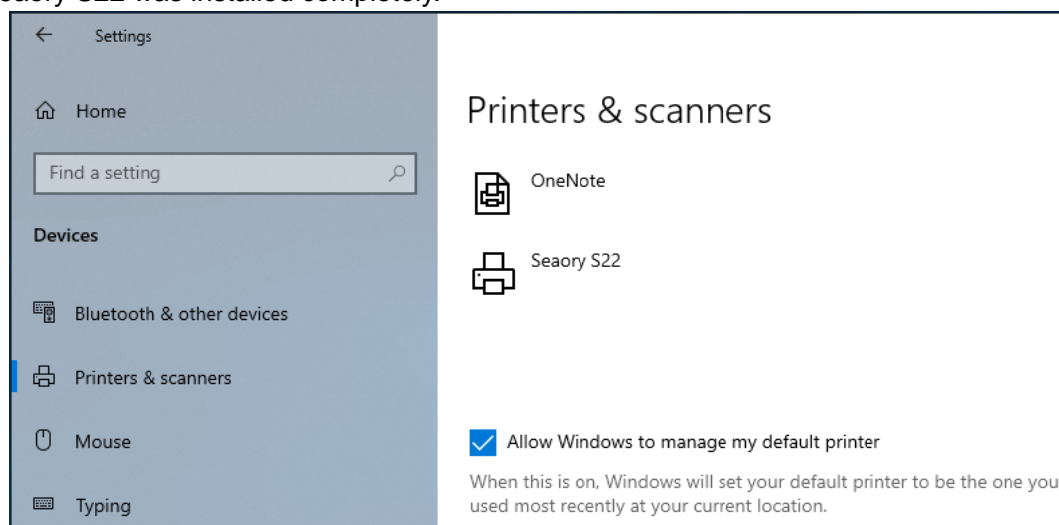

1.3.5 Settings of printing

Before using printer, please execute confirmation or alter the default settings.

Settings include:

- ◆ Type of ribbon ◆ Orientation ◆ Copies ◆ Feed card and Eject card



Please make sure fully knowing how to set the driver, otherwise, you shall ask for help from your local distributor before making any alternation.

Doing printing settings based on below steps:

- ① Click the button of “Start”, chose “Devices and Printers”
- ② Put your mouse on the selected printer, and click the right button, from the Printer menu, select “Printing preference”, then a window of it will come out.

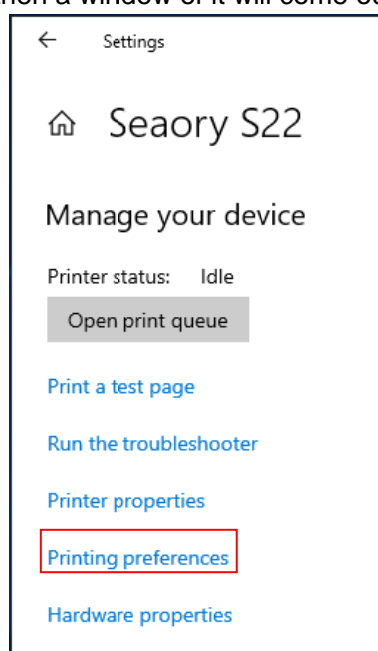

③ Printing preferences menu could be set the Print Option, Image Color, Print Area, Magnetic Encoding, Heating Energy and Tool etc.

In general, the most frequent use in print settings are Print Option and Tool.

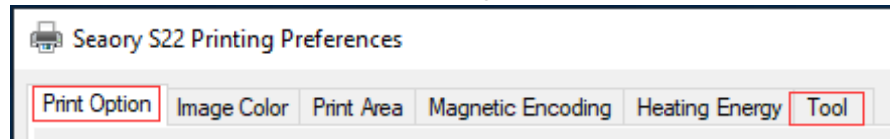

Seaory S22 Printing Preferences:

For model S22, Print Option includes settings of Ribbon Type, Printing Orientation/Copies, Color of front/ back side, In and Exit of card etc. The Tool contains settings of Adjust printing space, Cleaning printer, Magnetic strip tool, and it also indicates current Driver version, Serial number and language setting of the driver.

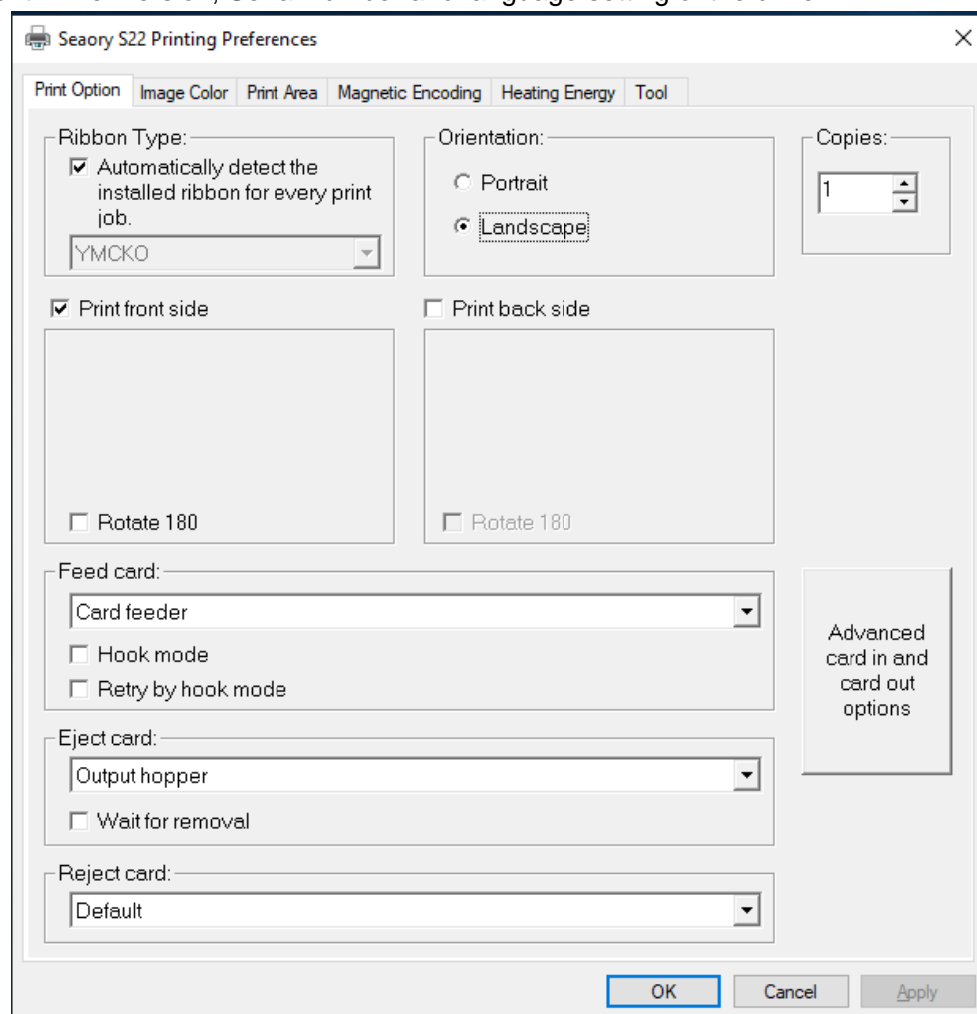

Ribbon Type:

Ribbon Type: <input checked="" type="checkbox"/> Automatically detect the installed ribbon for every print job. YMCKO	Orientation: <input type="radio"/> Portrait <input checked="" type="radio"/> Landscape
<input checked="" type="checkbox"/> Print front side <div style="border: 1px solid gray; height: 100px; width: 100%;"></div> <input type="checkbox"/> Rotate 180	<input type="checkbox"/> Print back side <div style="border: 1px solid gray; height: 100px; width: 100%;"></div> <input type="checkbox"/> Rotate 180

When click “Automatically detect the installed ribbon for every print job”, the color of front and back sides of card are same, which is color for the current ribbon. When current ribbon is full panel color ribbon or half panel color ribbon, the printed color will use YMCKO five blocks. When the ribbon is the monochrome ribbon, could be selected Black/White or Resin Dither.

Ribbon Type: <input type="checkbox"/> Automatically detect the installed ribbon for every print job. YMCKO	Orientation: <input type="radio"/> Portrait <input checked="" type="radio"/> Landscape
<input checked="" type="checkbox"/> Print front side <div style="border: 1px solid gray; padding: 5px;"> YMCKO YMCKO YMCO K EKO </div> <input type="checkbox"/> Rotate 180	<input checked="" type="checkbox"/> Print back side <div style="border: 1px solid gray; padding: 5px;"> YMCKO Print K: Black text, images and graphics </div> <input type="checkbox"/> Rotate 180

<p>Ribbon Type:</p> <p><input type="checkbox"/> Automatically detect the installed ribbon for every print job.</p> <p>YMCKO</p>	<p>Orientation:</p> <p><input type="radio"/> Portrait</p> <p><input checked="" type="radio"/> Landscape</p>
<p><input checked="" type="checkbox"/> Print front side</p> <p>YMCKO</p> <p>Print K:</p> <p>Black text, images and graphics</p> <p><input type="checkbox"/> Rotate 180</p>	<p><input checked="" type="checkbox"/> Print back side</p> <p>YMCKO</p> <p>YMCKO</p> <p>K</p> <p>KO</p> <p><input type="checkbox"/> Rotate 180</p>

<p>Ribbon Type:</p> <p><input type="checkbox"/> Automatically detect the installed ribbon for every print job.</p> <p>YMCKO</p>	<p>Orientation:</p> <p><input type="radio"/> Portrait</p> <p><input checked="" type="radio"/> Landscape</p>
<p><input checked="" type="checkbox"/> Print front side</p> <p>YMCKO</p> <p>Print K:</p> <p>Black text, images and graphics</p> <p>Black text, images and graphics</p> <p>Black text</p> <p>All black pixels</p>	<p><input checked="" type="checkbox"/> Print back side</p> <p>YMCKO</p> <p>Print K:</p> <p>Black text, images and graphics</p> <p><input type="checkbox"/> Rotate 180</p>

<p>Ribbon Type:</p> <p><input type="checkbox"/> Automatically detect the installed ribbon for every print job.</p> <p>YMCKO</p>	<p>Orientation:</p> <p><input type="radio"/> Portrait</p> <p><input checked="" type="radio"/> Landscape</p>
<p><input checked="" type="checkbox"/> Print front side</p> <p>YMCKO</p> <p>Print K:</p> <p>Black text, images and graphics</p> <p><input type="checkbox"/> Rotate 180</p>	<p><input checked="" type="checkbox"/> Print back side</p> <p>YMCKO</p> <p>Print K:</p> <p>Black text, images and graphics</p> <p>Black text, images and graphics</p> <p>Black text</p> <p>All black pixels</p>

When the “Automatically detect the installed ribbon for every print job” was cancelled, the color of front and back sides of card could be selected in YMCKO, YMCO or K. If the K was chose, the Print K option will come out, and could be selected between Resin Dither and Black/White.

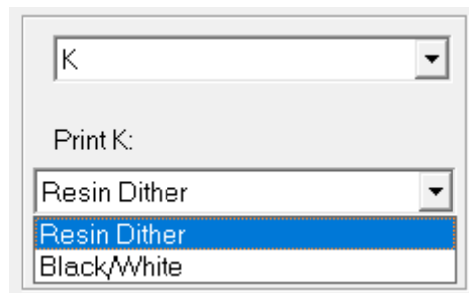

Printing orientation option: Available to set portrait or landscape printing, and Printing Copies could be set the number of printed card, the setting range is 1 to 99pcs.

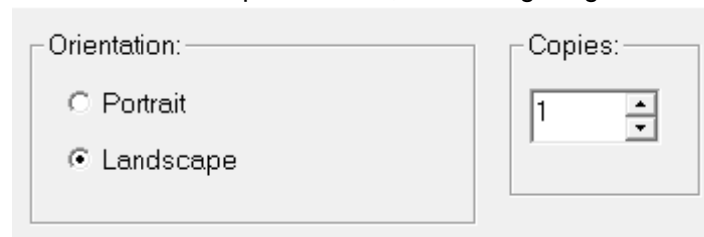

Feed card option: Available to set to Card feeder, Back end manual feed slot, and could be selected Feeding card by hook or Retry by hook mode. The eject card way, could be set to Output hopper, Reject tray or Do not eject card.

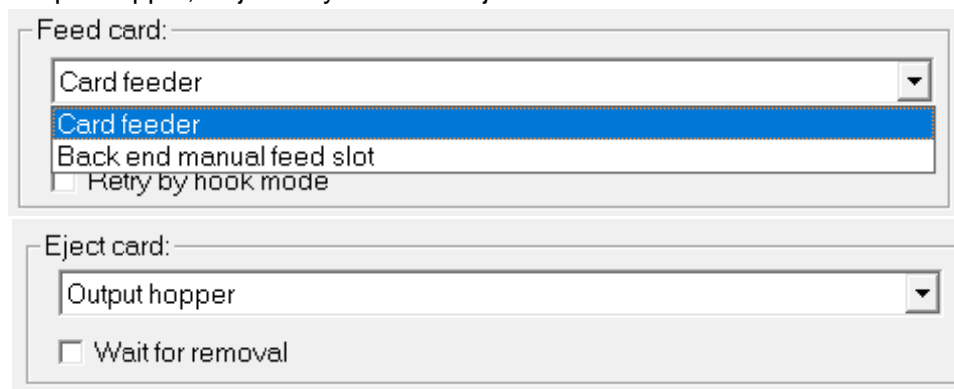

Reject card option: The reject cards could be returned into Default, Output hopper, Reject tray.

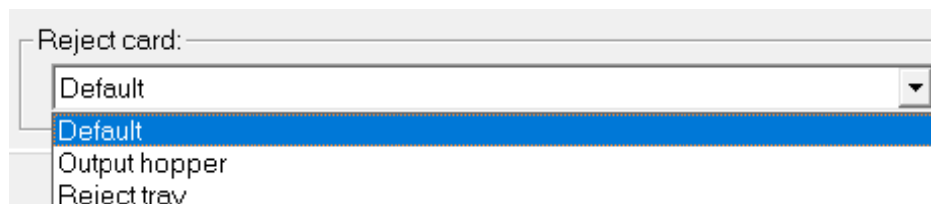

Advanced card in and card out options: Card Feeder option could be selected Enable card out sensor or not. Back end manual feed slot could be set Auto feed card when card is detected. Eject card could be set with Waiting card position and Waiting card time.

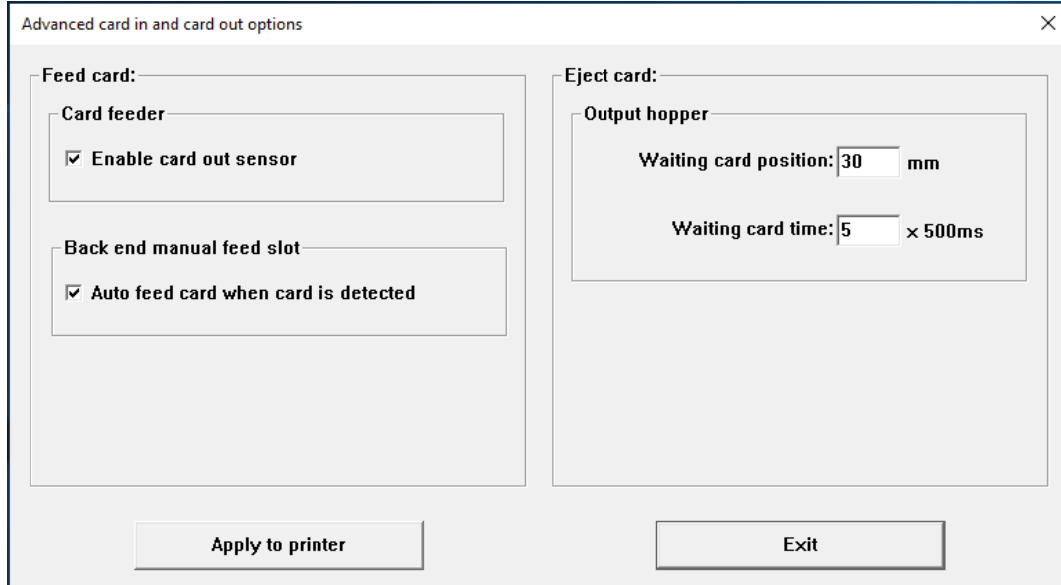

Advanced card in and card out options

Feed card:

Card feeder

☒ Enable card out sensor

Back end manual feed slot

☒ Auto feed card when card is detected

Eject card:

Output hopper

Waiting card position: 30 mm

Waiting card time: 5 × 500ms

Apply to printer Exit

Image Color option: Available to adjust the Brightness, Contrast, Sharpness, Yellow Balance, Magenta Balance, Cyan Balance, Gamma, Saturation and Black pixel RGB sum for printing by K of YMCKO

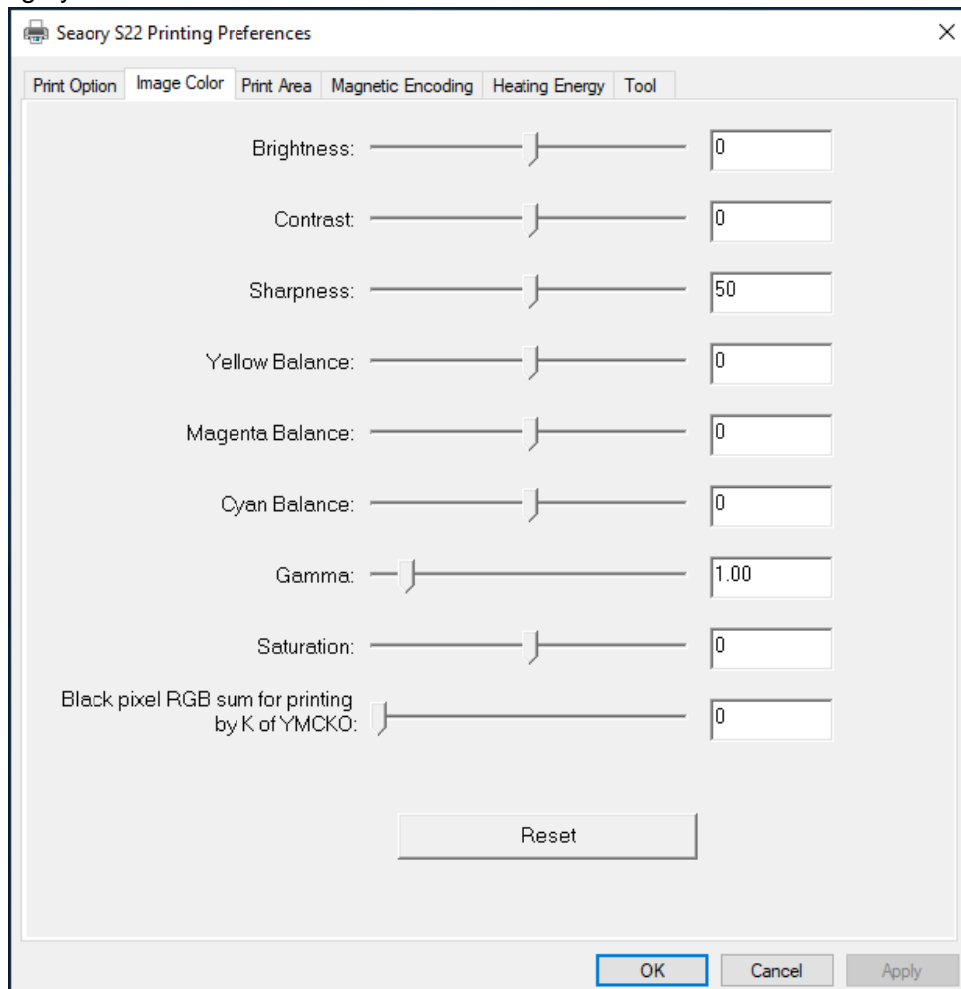

Seaoxy S22 Printing Preferences

Print Option Image Color Print Area Magnetic Encoding Heating Energy Tool

Brightness:

Contrast:

Sharpness:

Yellow Balance:

Magenta Balance:

Cyan Balance:

Gamma:

Saturation:

Black pixel RGB sum for printing by K of YMCKO:

Reset

OK Cancel Apply

Print Area option: Available to set the YMCO and K print area, and easy to locally print on card.

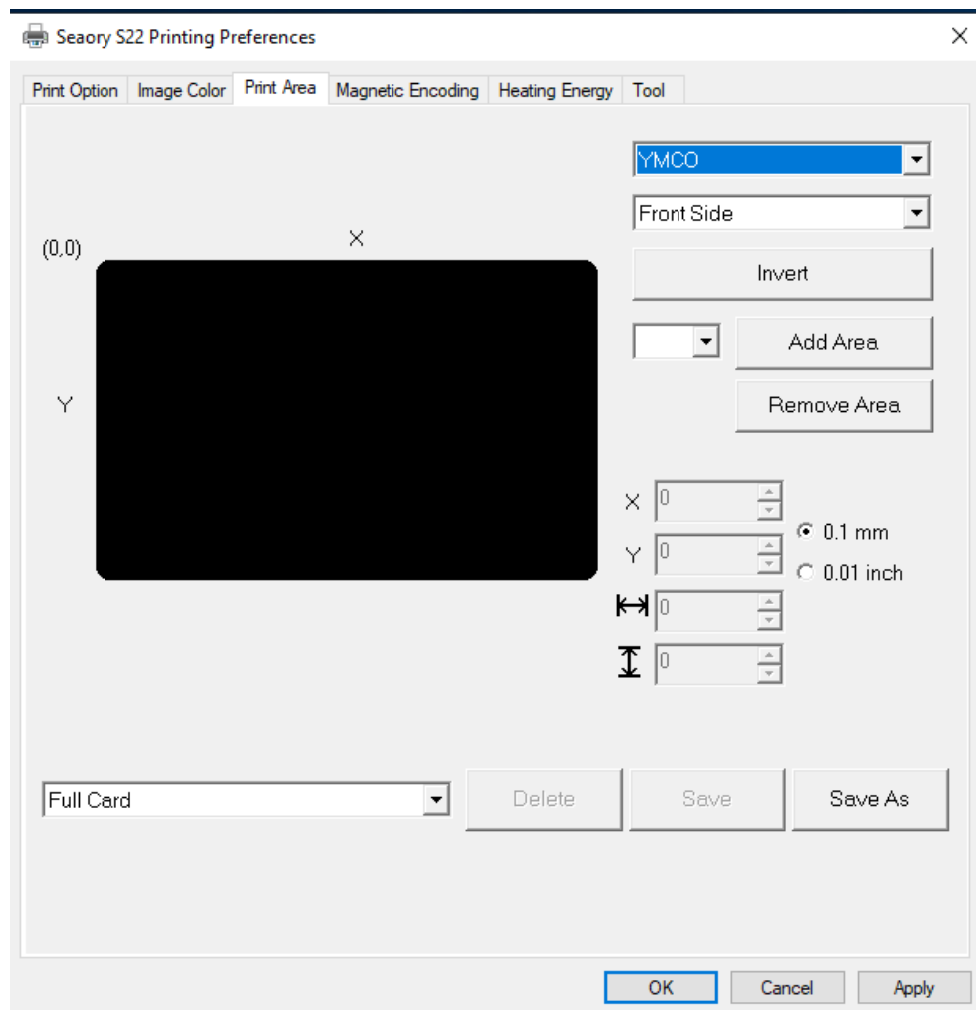

Magnetic Encoding option: For the card printer equipped with magnetic strip encoding module, available to encode for Low Co magnetic and High Co magnetic card. When encoding, could be define prefix and suffix of the encoding data to filter out.

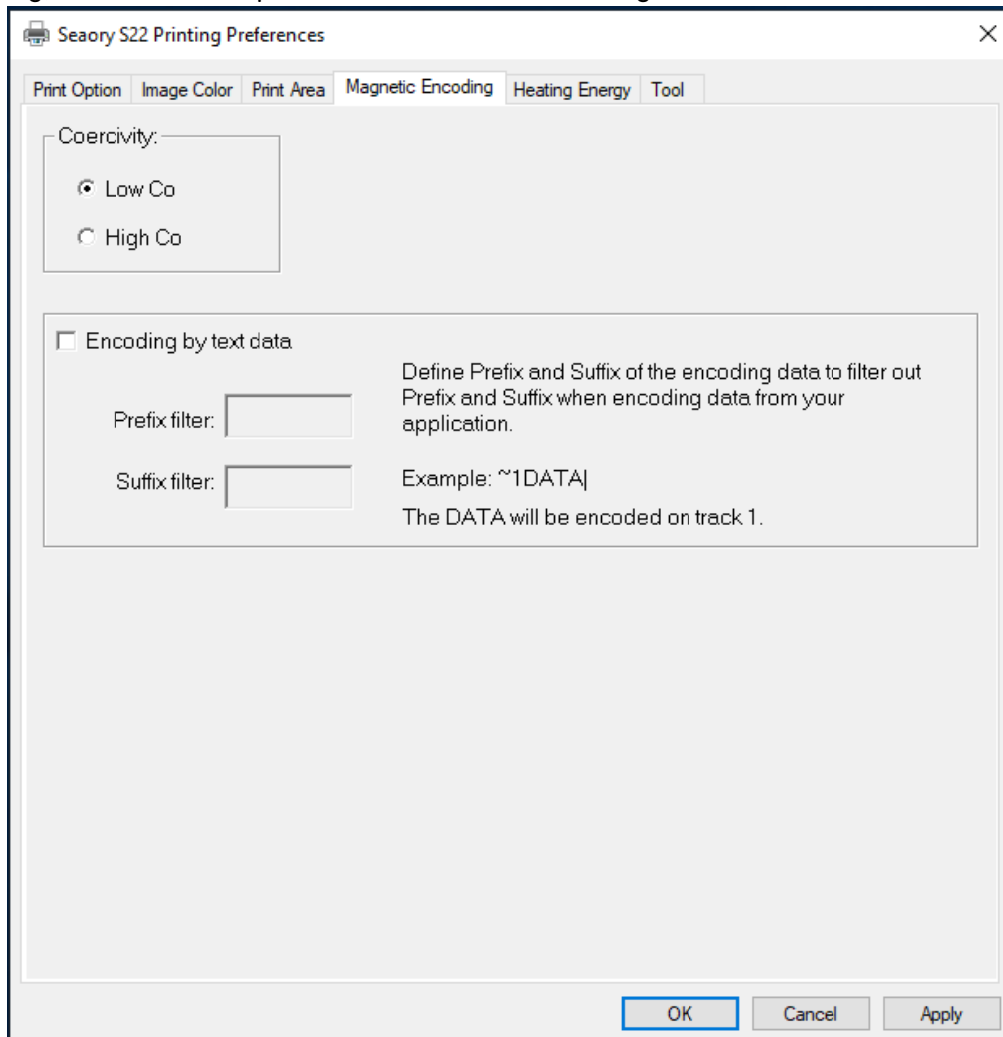

The image shows a screenshot of the 'Seatory S22 Printing Preferences' dialog box. The 'Magnetic Encoding' tab is selected. It contains two radio buttons for 'Coercivity': 'Low Co' (selected) and 'High Co'. Below this is a checkbox for 'Encoding by text data'. When this checkbox is checked, it enables two text input fields: 'Prefix filter:' and 'Suffix filter:'. To the right of these fields, there is explanatory text: 'Define Prefix and Suffix of the encoding data to filter out Prefix and Suffix when encoding data from your application.' and an example: 'Example: ~1DATA|' followed by 'The DATA will be encoded on track 1.' At the bottom right, there are three buttons: 'OK', 'Cancel', and 'Apply'.

Seatory S22 Printing Preferences

Print Option Image Color Print Area **Magnetic Encoding** Heating Energy Tool

Coercivity:

☒ Low Co

☐ High Co

☐ Encoding by text data

Prefix filter:

Suffix filter:

Define Prefix and Suffix of the encoding data to filter out Prefix and Suffix when encoding data from your application.

Example: ~1DATA|

The DATA will be encoded on track 1.

OK Cancel Apply

Heating Energy option: Available to adjust the heating energy when color of card is too dark or light.

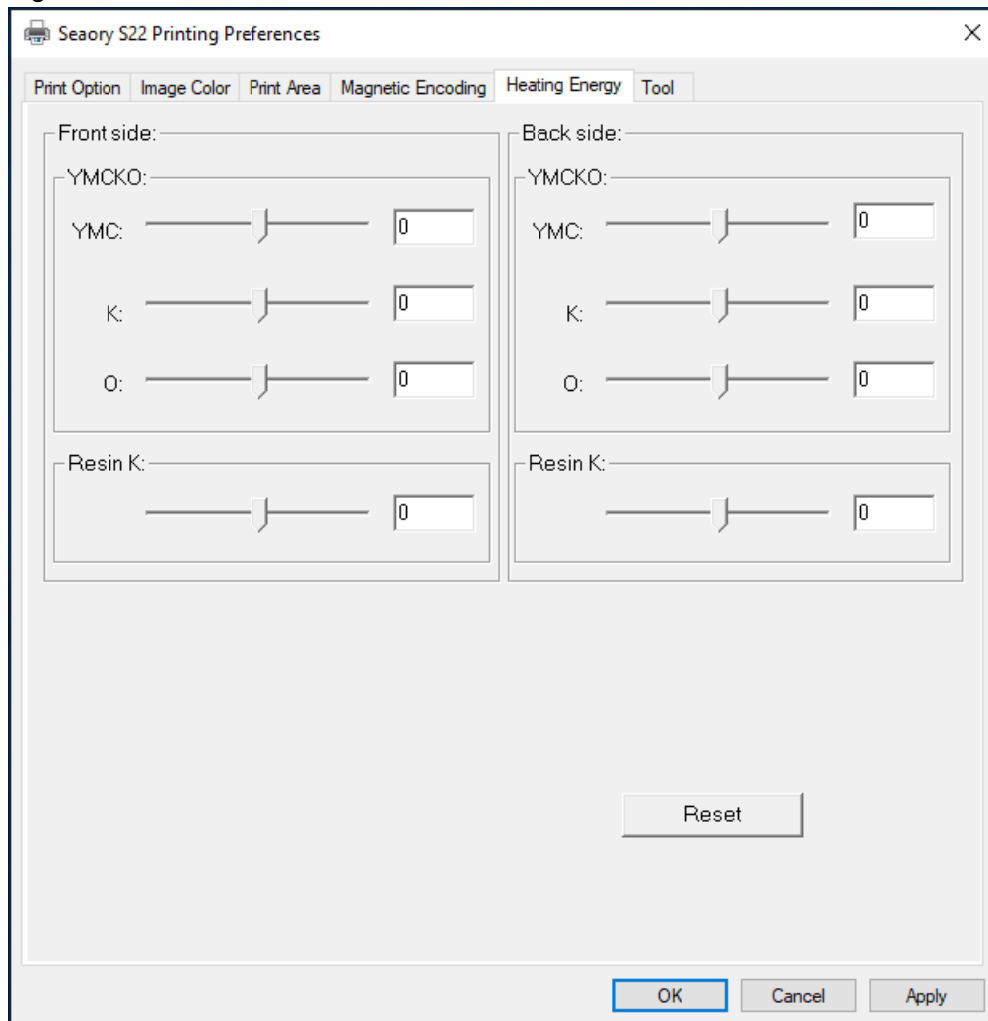

The screenshot shows the 'Seaory S22 Printing Preferences' dialog box with the 'Heating Energy' tab selected. The dialog has a title bar with a close button (X) and a tabbed interface with the following tabs: 'Print Option', 'Image Color', 'Print Area', 'Magnetic Encoding', 'Heating Energy', and 'Tool'. The 'Heating Energy' tab is active and contains two main sections: 'Front side:' and 'Back side:'. Each section has a 'YMCKO:' label and three sliders for 'YMC:', 'K:', and 'O:', each with a numeric input field set to '0'. Below these, there is a 'Resin K:' label and a single slider with a numeric input field set to '0'. A 'Reset' button is located at the bottom center of the dialog. At the bottom right, there are three buttons: 'OK' (highlighted with a blue border), 'Cancel', and 'Apply'.

Tool option: Available to check the Ribbon type, Remain count, Region Code, Firmware version, Serial number, Driver version, Date, also available to correct Printing Position, Cleaning Tools and Magnetic Strip Tool, and set language of driver.

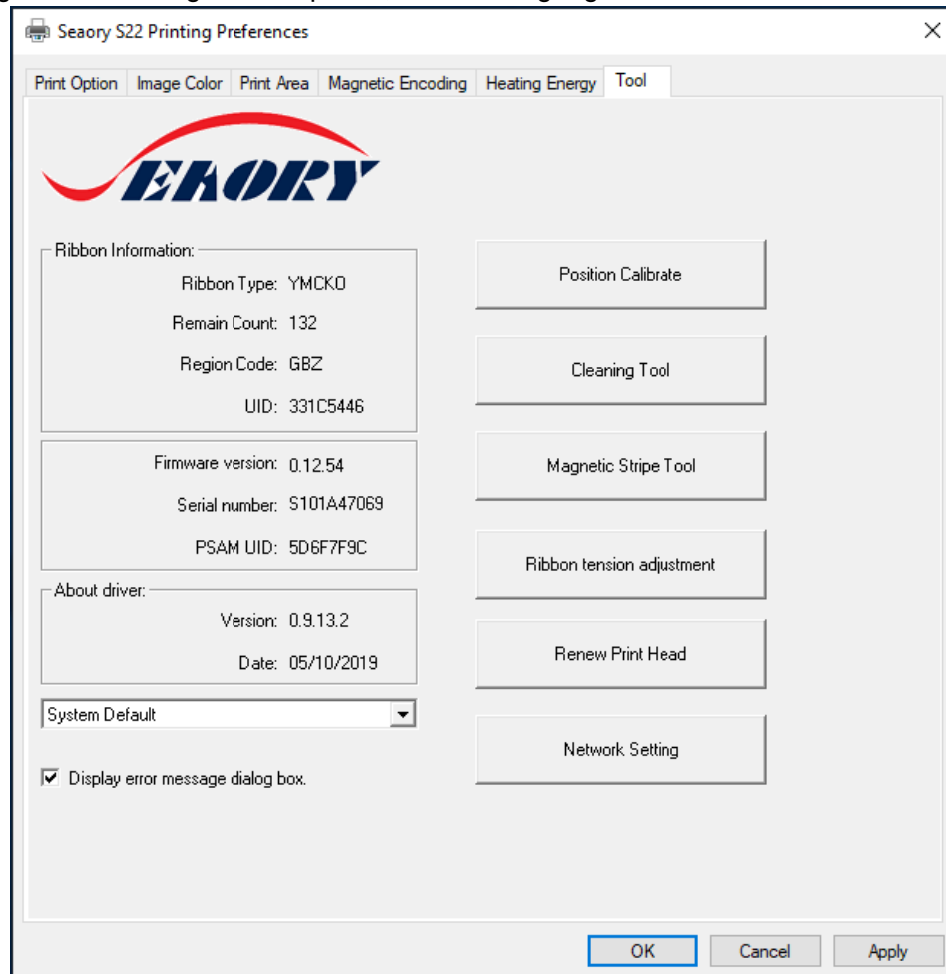

Showing printer related information:

1. Ribbon Information: Ribbon Type, Remain Count, Region Code, UID.
2. Firmware version, Serial number, PSAM UID.
3. Driver version and date.



Printer driver language setting:

- 1.System Default: According to the operating system language automatically to set up.
- 2.English
- 3.Simplified Chinese
- 4.Traditional Chinese
- 5.German
6. Spanish
7. Portugal
8. French

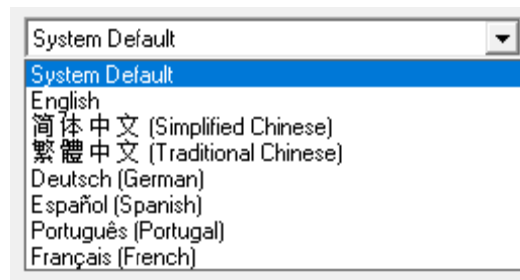

Seatory Print Position Calibrate Tool: To correct the printing position when the white edge appears on card, and no correction is required by default.

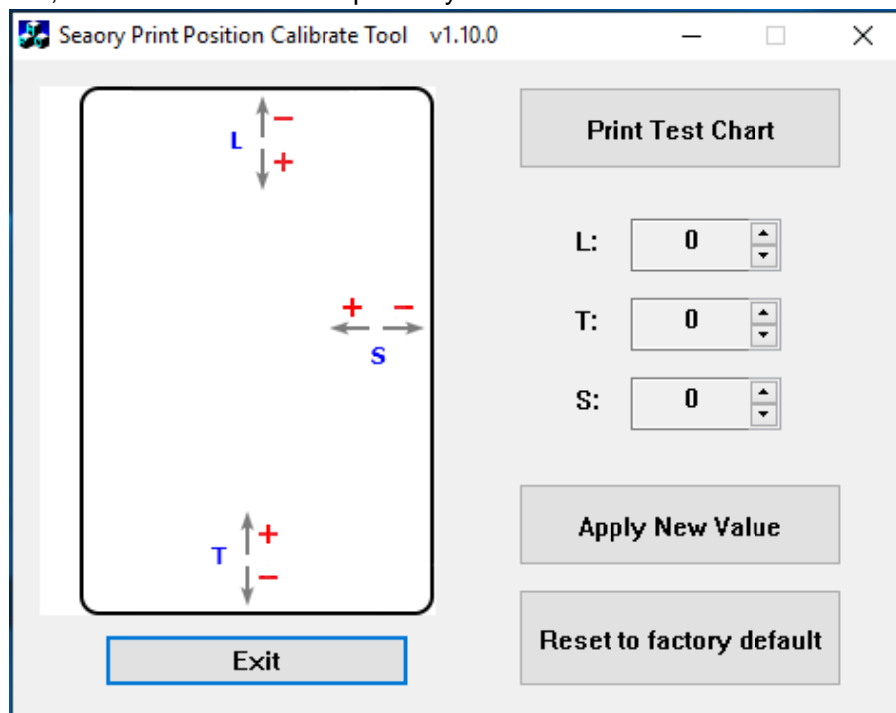

Cleaning Tool: To use the cleaning tool and cleaning card to clean the printer when the printer is used for a while. Please take out ribbon carriage, remove the transparent film on both sides from the cleaning card and place it in the feeder, then click “OK” button to begin the process.

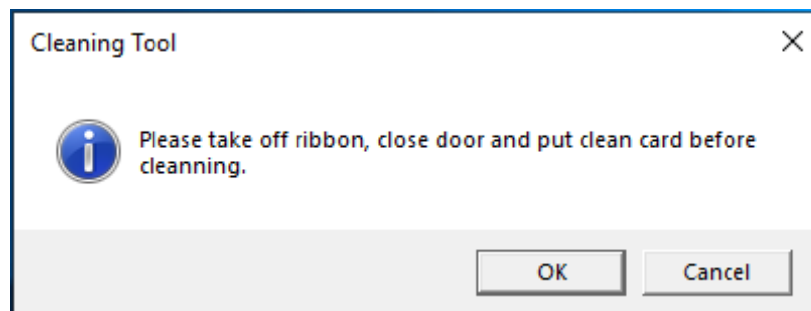

Magnetic Stripe Card Tool: The tool is valid for printers which equipped with magnetic stripe card encoding module, and could read and write the data for 3 tracks of Low Co and High Co magnetic stripe card.

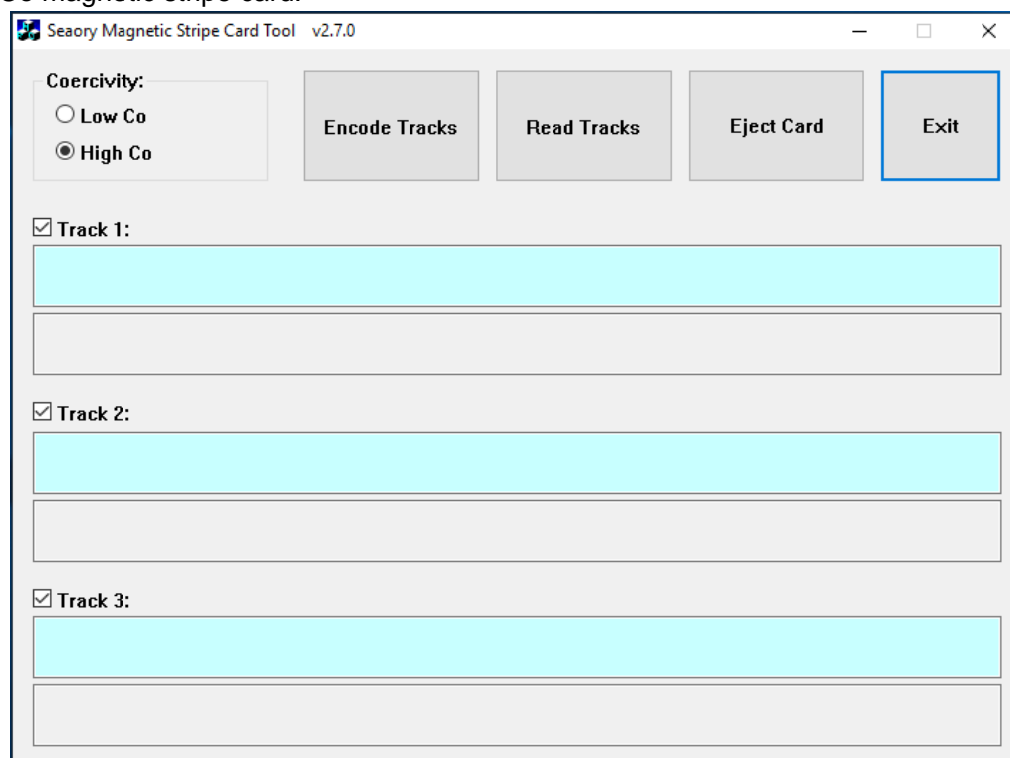

Ribbon tension adjustment: Available to increase or decrease the tension of red ends and white ends.

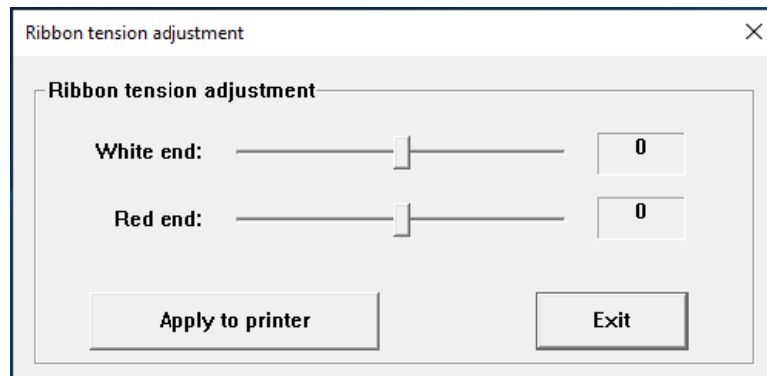

Seaory Print Head Replacement Tool: When replacing a new printhead, you need to enter the barcode information on the printhead.

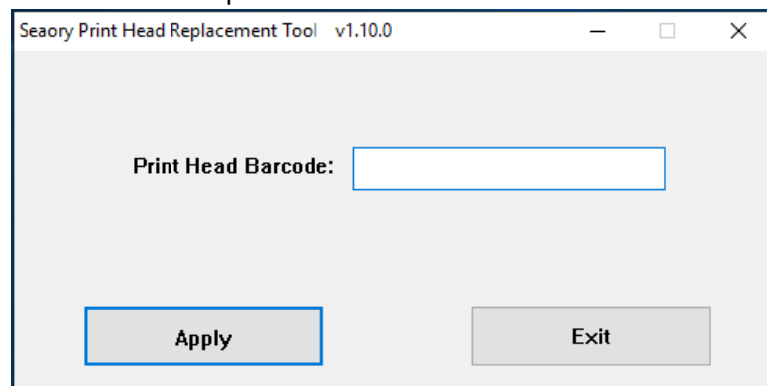

Seaory Card Printer Network Configuration tool: When selecting the network setting, a “Sailer card machine network setting tool” dialog box will appear, through which you can set the fixed IP address of the connected printer (two ways to set, One is through the USB port and the other is through the Ethernet interface).

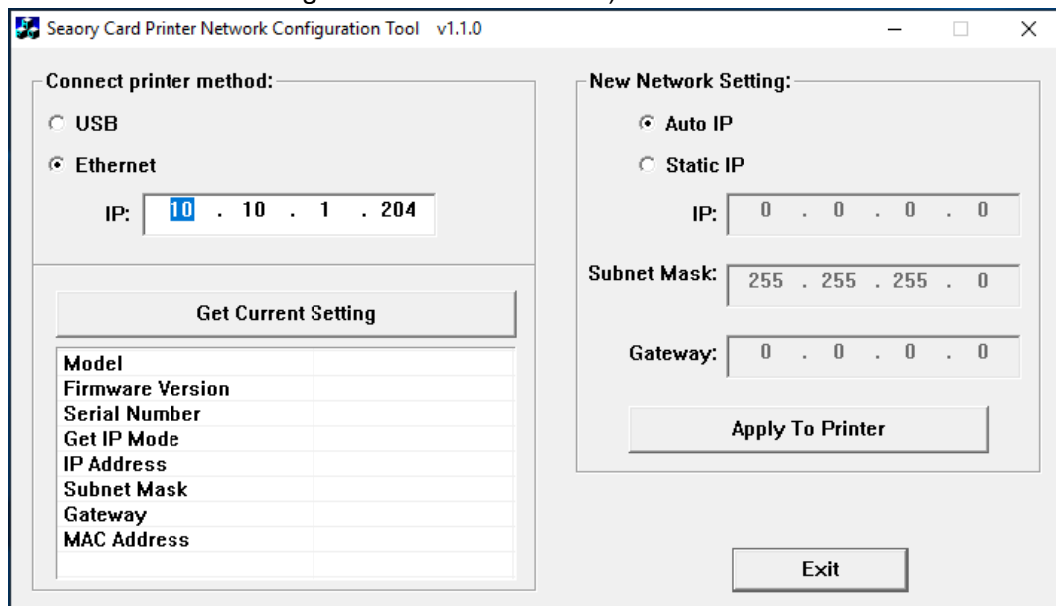

Chapter II Maintenance of Printer

2.1 Cleaning the card passage by cleaning card

In order to get a good printing effect, please clean the card passage by cleaning card after one ribbon run out by below steps:

- a. Get one cleaning card out from the accessory box, remove the transparent film on front and back side, and put it into the hopper.
- b. Press the button of "OK" when printer is ready.

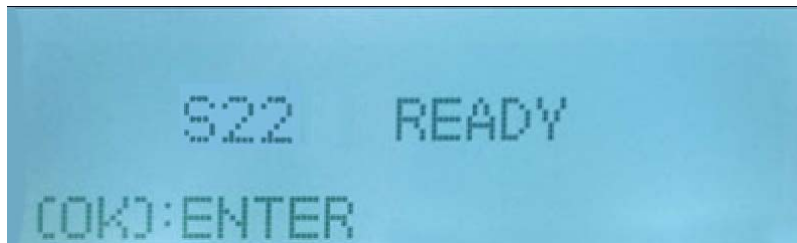

- c. "Printer information" shown on the LCM

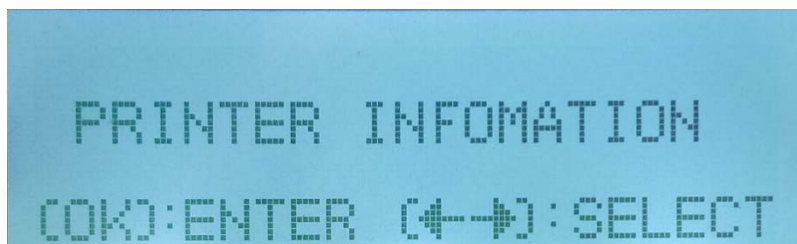

- d. Press the button of "<", "Cleaning function" appears and press "OK"

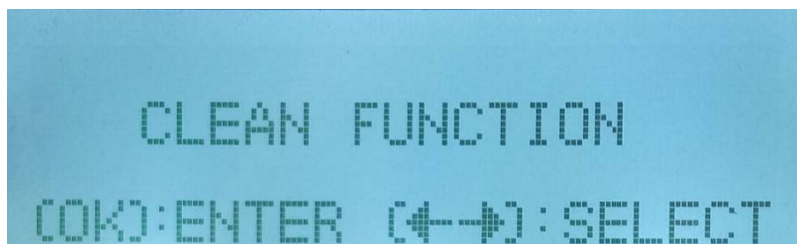

- e. It shows "Open the cover" on the LCM, then open it, and press "OK"

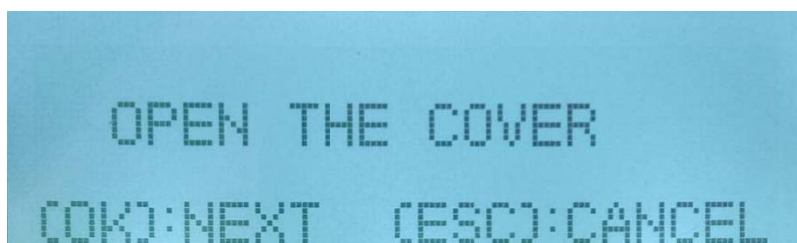

f. It shows "Take out of ribbon" on the LCM, then get it out from the printer, and press "OK".

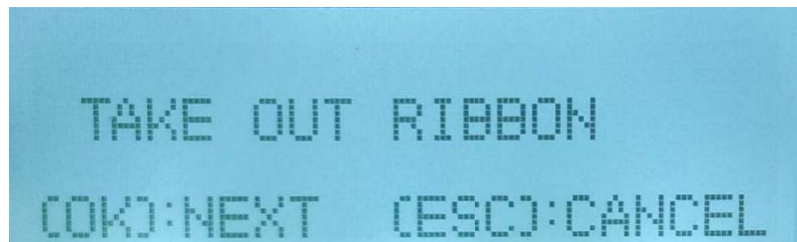

g. Cleaning card has run into the printer, and the LCM shows "Cleaning...", which means it is cleaning the card passage. Please do not operate any buttons, and wait for printer cleaning to finish.

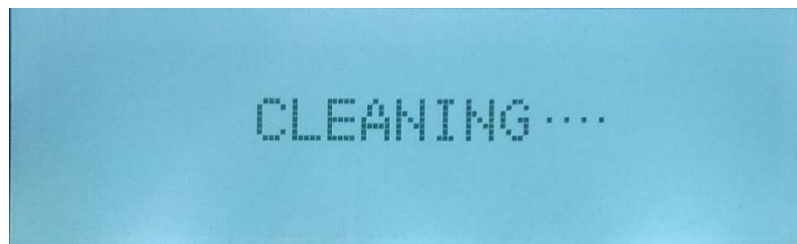

h. After the cleaning, the cleaning card will get out, and LCM says cover open.

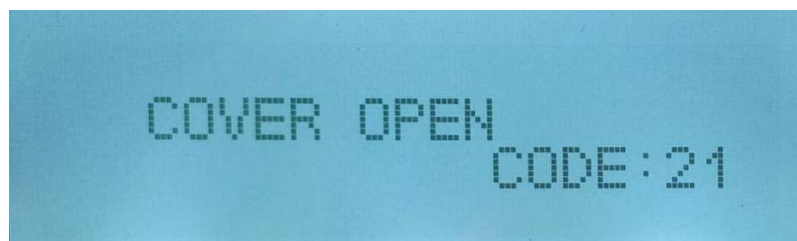

i. Put the ribbon carriage with ribbon into the printer, and slowly close the cover, while the LCM says system is initializing.

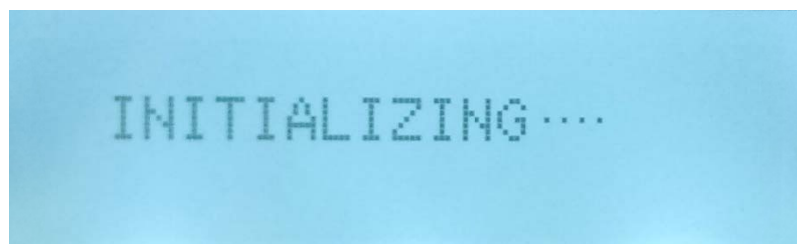

j. After the initializing, LCM says printer is ready.

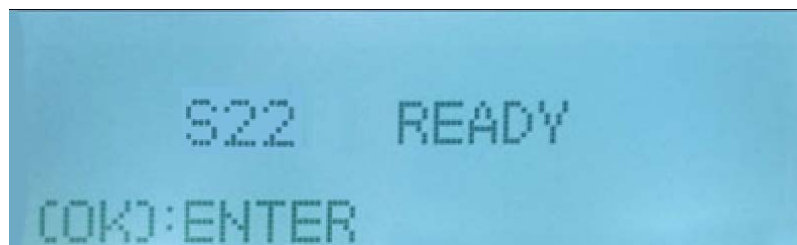

2.2 Cleaning printer head



Please make sure the power socket is disconnected before cleaning printer head. Try not to make any direct physical contact to printer head with any metal/sharp objects or your fingers. The printer head and its components must be kept away from any discharge of static electricity.



To optimize printing quality, please engage in printer head cleaning every time when the ribbon is changed.

- a. Press top button to open cover gently, you could see the printer head.
- b. Please clean the printer head with the cleaning rod include in the accessory box.

Note:

1. Please do not touch the print head with hands.
2. Please do not use cleaning liquid to clean the print head.

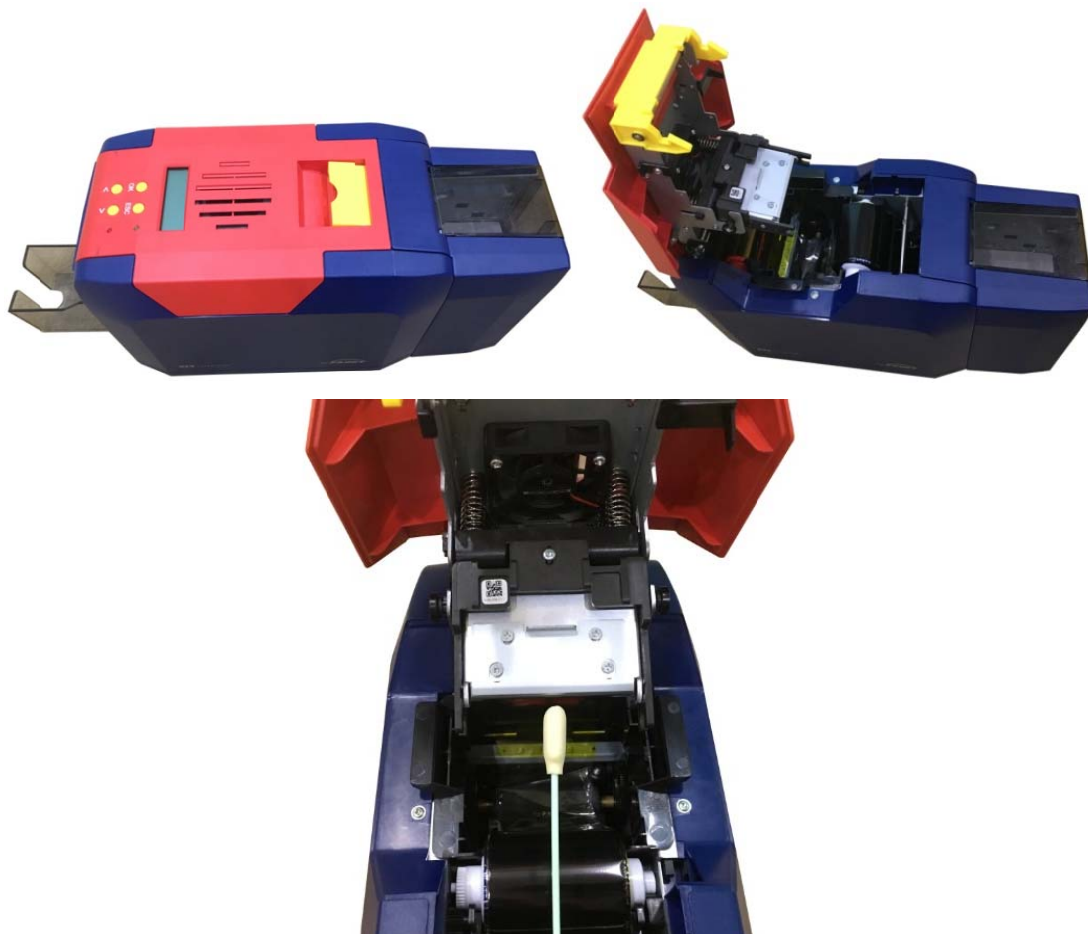

Chapter III Tips for Solving Problems

3.1 Warning and Tips for Errors

3.1 Warning and Tips for Errors

Some ordinary problems can be solved through clues on LCM

a. LCM Control Panel

This printer is equipped with a LCM showing printer status and warning errors, and 4 controlling buttons.

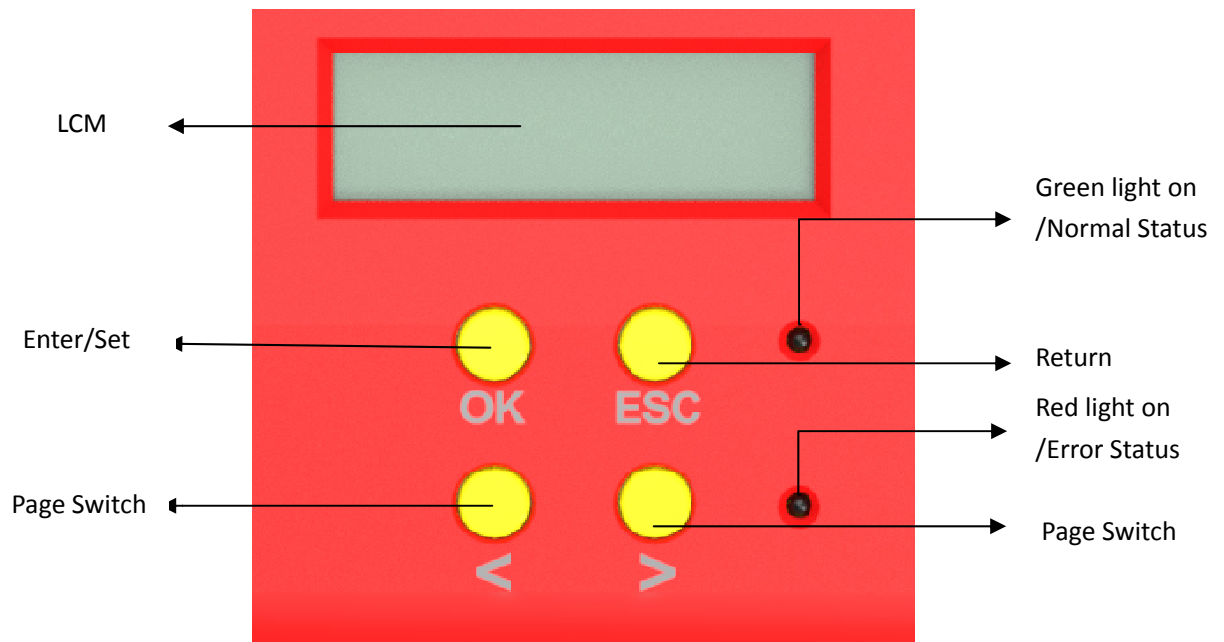

Normal status: Green light is on.



Error status: Red Light is on, please follow the tips on LCM to operate next step, and eliminate abnormal situations.

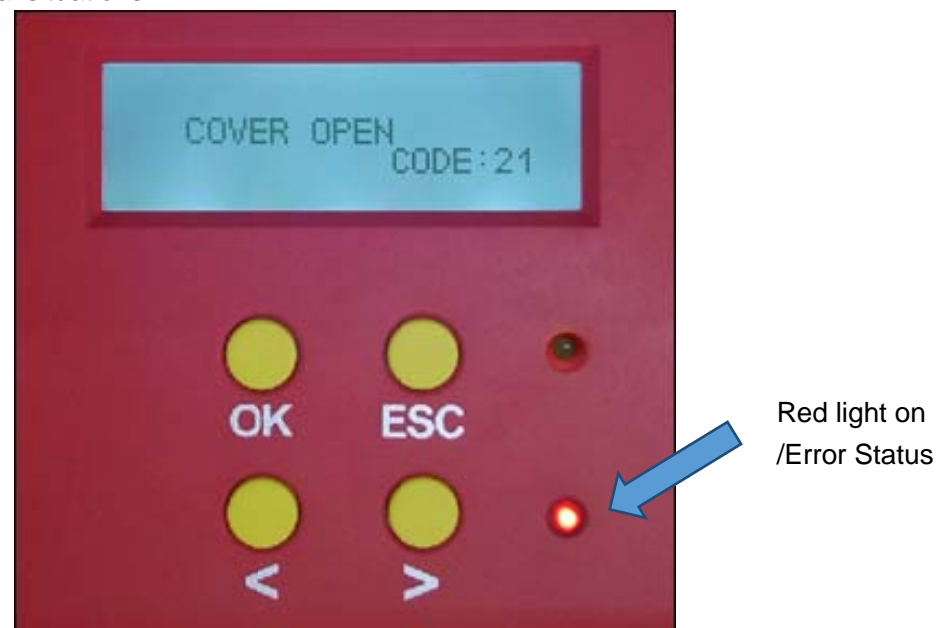

b. Check driver and software version

You can check the installed driver version in the Printing Settings. You are suggested to download our latest driver on our official website occasionally.

